

OREGON CORNER RESTORATION FORM

Section 31 Township 1N Range 32E
 County Umatilla Date: September 15, 2009

Corner Designation: 1N32X5

Quarter corner common to sections 31 and 32,
 T1N, R32E, W.M., Umatilla County, Oregon.

Condition Report Only
 Not found
 Remonumented
 Unrecorded
 Surveyed in
 Referenced out

Previous Renewals / Surveys, etc.

Corner originally set by Daniel Chaplin under contract No. 107 Dated September 21, 1864. His record reads: Set post for 1/4 section corner in mound of earth with charred stake, pits, etc., as per instructions. Aubrey Perry in record of survey in Book 2, Page 317 dated September 5, 1921 stated: Set rock 5" x 10" x 12".

Monument and Accessories found: (condition and source)
 None. The point falls in the center of the county road.

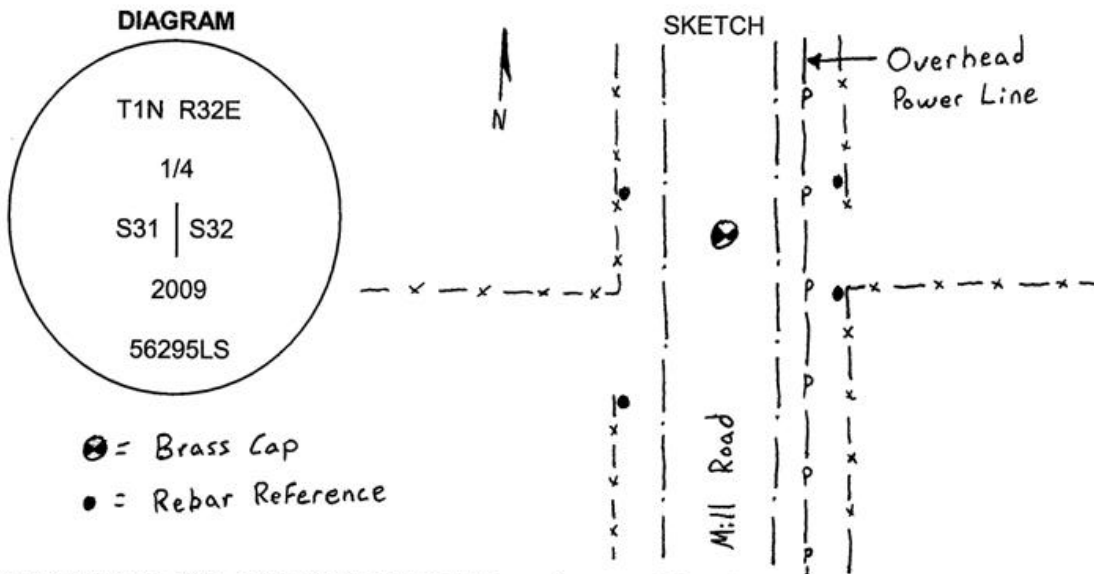

MONUMENT (S) AND ACCESSORIES SET (Procedures and Description)

I set a 5/8"x15" copper coated iron rod with a 2 1/2" brass cap stamped as shown in the diagram above at the proportioned point. I cemented the cap into the asphalt with liquid nails.

For references, I set four 5/8" by 24" iron rebars with 1 1/4" orange plastic caps stamped WTS and 56295LS as described below:

- an iron rebar bears N74°42'42"W, 32.79 feet;
- an iron rebar bears N62°36'54"E, 33.61 feet;
- an iron rebar bears S40°22'40"E, 45.74 feet;
- an iron rebar bears S22°37'34"W, 68.84 feet;

The monument was set and references tied using a Trimble R7/R8 RTK GPS system.

Location and comments
 NAD 83/1991 State Plane Coordinate
 Oregon North Zone
 N = 680,916.65 ft
 E = 8,625,283.28 ft

Compass Declination

Surveyors Seal

RECEIVED BY:
Umatilla County Surveyor
 Date: 6-10
 Rec'd By: RF
 No. 10-93-c

Firm / Agency
 Witness Tree Surveying
 Address
 P.O. Box G
 Pilot Rock, OR 97868
 Party Chief
 Stephen K, Haddock

REGISTERED
 PROFESSIONAL
 LAND SURVEYOR

Stephen K. Haddock

OREGON
 JULY 9, 2001
 STEPHEN K. HADDOCK
 56295LS

RENEWAL DATE 6-30-11