

OREGON CORNER RESTORATION FORM

Section 3 Township 1N Range 34E

County Umatilla Date 9/16/87

E-15

Corner Designation

Quarter Corner
between 3 and 10



- Condition Report Only
- Not Found
- Renewed
- Unrecorded
- Surveyed In
- Referenced Out

Previous Renewals/Surveys, etc.

Gov't. Indian Allotment survey, 1919.

Monument(s) & Accessories Found: (Condition and Source)

Found brass cap on a 2" iron pipe at top of a cut bank of gravel road.

Monument Detail

Sketch

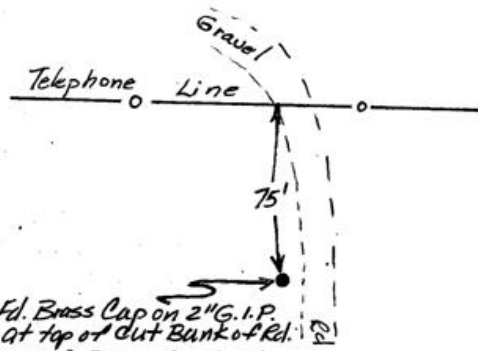

Monument Set (Procedures and Description)

New Accessories

Location & Comments

Blue Mountain Forest
Wayside Boundary
survey, SE 1/4 Sec. 4, &
S 1/2 Sec. 3.

Compass Declination 20°

Firm/Agency Oregon State
Parks & Recreation Div.

Address 525 Trade Street SE
Salem OR 97310

Party Chief R. Hemmer

Notes R. Hemmer

Witness L. Boge, H. Hanson

Seal

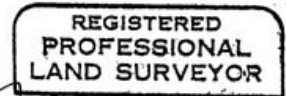

John E. Hollingsworth

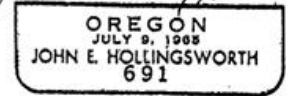

RECEIVED BY

Umatilla County Surveyor

Date 2-88

Rec'd By AE

No. 88-10-B