

**CERTIFIED RECORD OF LAND CORNER MONUMENTATION**

**HISTORY OF ORIGINAL CORNER ESTABLISHED:**

Corner originally established by Z. Moody under GLO contract 145 dated April 23rd, 1871. Surveyor General field notes state:

Set Basalt stone 18x12x10 for corner to secs. 9,10,15,16.

Corner monumented by James Currin and James Noland under special GLO contract dated May 4, 1887. Surveyor General field notes state:

Set basalt stone 16x10x8 in, 11 ins. in the ground marked 4 notches on S. 3 notches on E. edges. for cor to Secs 9, 10, 15 and 16, raised mound of stone around it.

Corner remonumented by L.E. Wilkes in Resurvey of the Diminished Umatilla Indian Reservation under Special Instructions dated Feb. 20, 1917, included in Group No. 29. Field notes state:

Intersect the cor. of secs. 9, 10, 15, and 16, which is a basalt stone, 16x12x6 ins., loosely set in a mound of stone, marked with 5 notches on S. and 3 notches on E. edge. I reset this stone 9 ins. in the ground, and at a point 1 lk. E. of cor. Set an iron post, 3 ft. long, 2 ins. diam., 24 ins. in the ground, for witness cor. to the cor. of secs. 9, 10, 15, and 16, with brass cap marked, from which:

A pine, 12 ins. diam., bears N.32°30'W., 34 lks. dist., marked T1NR34ES9DRBT  
No other tree available. Raise a mound of stone, 3 ft. base, 2 ft. high, W. of cor.

**DESCRIPTION OF CORNER EVIDENCE FOUND:**

Found a 2" iron pipe with 2 ¼" Brass cap 12" above ground, from which:

A 24" Ponderosa Pine bears North 32° West, a dist. of 22.45 ft., alive and vigorous with healed blaze.

A stone mound buried in pine needles 12 in. deep bears West approx. 3 ft.

**DESCRIPTION OF MONUMENT AND ACCESSORIES I ESTABLISHED TO PERPETUATE THE ORIGINAL LOCATION OF THIS CORNER:**

From Iron pipe monument,

**NEW BEARING OBJECTS:**

A 5/8"x30" iron pin bears South 34°12' East a dist. of 17.45 ft., with 1 ½" aluminum cap marked SE RP.

A 5/8"x30" iron pin bears South 29°37' West a dist. of 15.78 ft., with 1 ¼" aluminum cap marked SW RP.

A 20" Ponderosa Pine bears North 12° West a dist. of 13.15 ft., with 1 ½" aluminum cap marked T1N R34E S9 BT.

Falls on spine of South Westerly sloping ridge in old fence corner from which fences bear North, East, and West.

I hereby certify that the corner was perpetuated on May 1st, 2019.  
Witness: Kyle A. Tucker

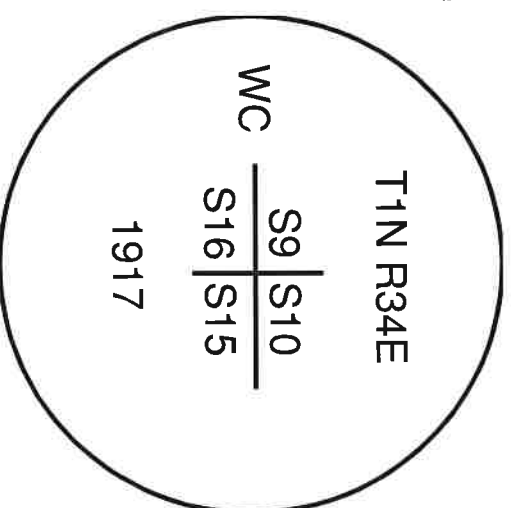
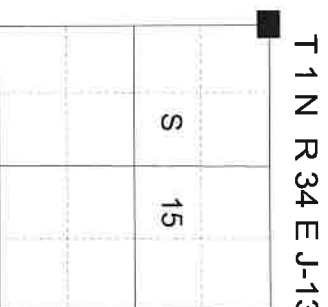
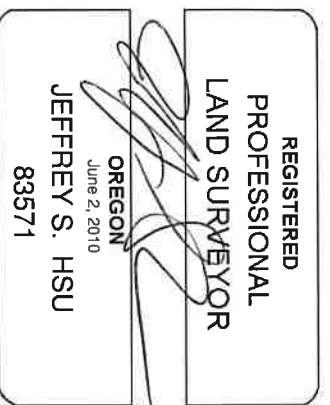

I used a Leica GS18 RTK GPS in the establishment of the new iron pin accessories. Basis of bearing is as per Survey for CTUIR dated May 2019. I use a compass and steel tape for bearing tree accessories. I used 13° East declination. The bearings are to a brass washer marked "OPLS 83571" nailed to the BT blaze for the tree accessories and to the center of the aluminum cap for iron pin. Distances are to a 60D spike nailed to the right side of the base of the tree or the center of the aluminum cap.

Renewal Date: June 30, 2019