

CERTIFIED RECORD OF LAND CORNER MONUMENTATION

HISTORY OF ORIGINAL CORNER ESTABLISHED:

Corner was originally established by David Krumbein in Umatilla County Survey H-225-B. Survey record states:

Set Br. Cap

T 1 N R 35 E S-17

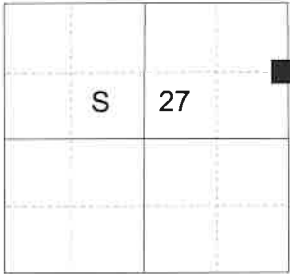

DESCRIPTION OF CORNER EVIDENCE FOUND:

Found a 2 1/2" galvanized pipe with 2 1/2" brass cap marked as shown, 8" above ground, which bears South 73°10'59" West, a dist. of 12.39 feet, from true position.

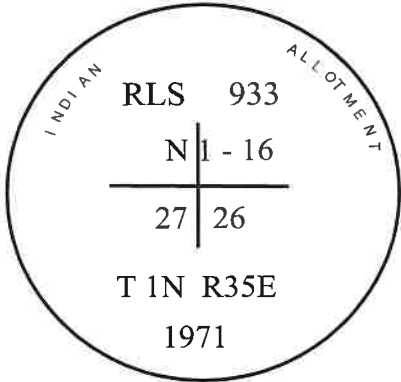

DESCRIPTION OF MONUMENT AND ACCESSORIES I ESTABLISHED TO MONUMENT THE ORIGINAL LOCATION OF THIS CORNER:

At position by survey I set a 5/8" x 30" iron pin, 29" in the ground, with 2 1/2" aluminum cap marked as shown below, from which:

NEW BEARING OBJECTS:

An 11" Ponderosa Pine bears South 78° West, a dist. of 7.65 feet, marked N 1/16 S27 BT.
A 6" White Fir bears South 52° East, a dist. of 13.75 feet, marked N 1/16 S26 BT.

Set steel fence post approx. 0.5 ft. Northeast

I hereby certify that the corner was monumented November 11, 2025

Witness: Kyle Tucker, Nick Peckham

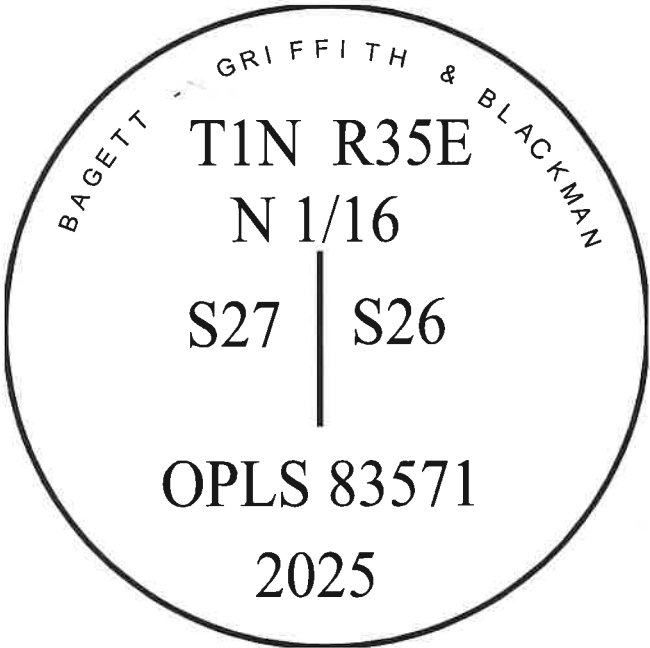

Renewal Date: June 30, 2027

I use a tape and compass in the establishment of the new bearing trees. Bearings are measured from the center of the aluminum cap to a brass washer marked "OPLS 83571" tacked to the BT blaze using 14° East for declination. Distances are measured to from the center of the brass cap to a 60D spike in the center right base of the tree.