

OREGON CORNER RESTORATION FORM

Section 28 Township 1 N. Range 35 E.

County UMATILLA Date 9-10-91

Corner Designation

SOUTH 1/4 CORNER
SECTION 28

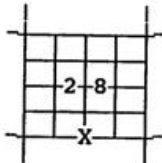

- Condition Report Only
- Not Found
- Renewed
- Unrecorded
- Surveyed In
- X Referenced Out

Previous Renewals/Surveys, etc.
Staebler 1969 C.S. # F-24-AX
Krumbien 1976 C.S. # F- 9-AX

Monument(s) & Accessories Found: (Condition and Source)
Found 2" diameter Iron Pipe PER Staebler - 18" high with wood plug, in north-south partly down barbed-wire fence.
Old fencing (barbed wire) runs west.
Old S.H.R.W. (State Highway Right-of-Way) post 5' north.

Monument Detail

2 inch diameter IRON PIPE

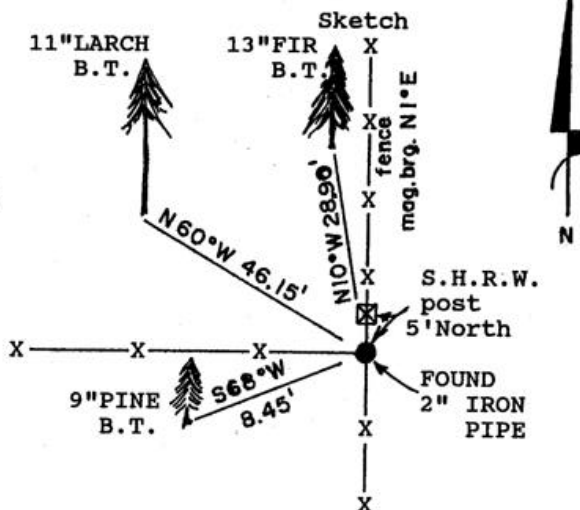

Monument Set (Procedures and Description)
NONE

New Accessories

- Found County Tag on 9" Lodgepole PINE 8.45' to center S 68°W we scribed 1/4S33BT on plain pre-blazed face.
- 11" LARCH 46.15' to center N60°W we scribed 1/4S28BT.
- Found County Tag on 13" DOUGLAS FIR 28.90' to center N 10°W we scribed 1/4S28BT.

Location & Comments
As set by single proportion by Staebler in 1969. B.T. faces painted yellow.

Compass Declination 20°E
by:
Oregon State Parks & Recreation Department
525 Trade Street, S.E.
Salem, OR 97310

Surveyor's Seal

RECEIVED BY
Umatilla County Surveyor
Date 4-92
Rec'd By KK
No. 92-44-R

Party Chief: Andy Blachly
Notes: Andy Blachly P.L.S. #2168
Witness: Curtis Smith
Parks Employee

REGISTERED
PROFESSIONAL
LAND SURVEYOR

ATB

OREGON
JULY 26, 1905
ANDREW T. BLACHLY
2168