

OREGON CORNER RESTORATION FORM

COUNTY: Umatilla DATE: 8/25/95

CORNER DESIGNATION: V-3. South 1/4 corner Section 30, T1N., R35E., W.M.

PREVIOUS RENEWALS/SURVEYS, ETC.: Corner originally established by James P. Currin and James Noland under Special Contract dated May 4, 1887.

Surveyor General records state:
Set basalt stone 9 x 8 x 7 ins., 6 ins. in the ground for 1/4 S. cor., marked 1/4 on N face; raised mound of stone over it. Pits impracticable.

MONUMENT AND ACCESSORIES FOUND: None. Corner position is on very steep mountainside which has been heavily trampled by bovine and wildlife. The corner stone and mound are presumed to have rolled downhill.

MONUMENT MARKING DETAIL:

T1N R35E
1 S30
4 S31
1995
ORLS 1639

MONUMENT SET: At the calculated proportional position between recovered adjacent section corners East and West, set a 5/8" x 30" iron rod with a 1 1/2" diameter aluminum cap, projecting 6" with a 2 foot mound of stone, marked as shown in monument marking detail.

From which:

- A 6" ponderosa pine with double blaze scribed "X BT", bears S 27° E, 50.7 feet.
- A 9" ponderosa pine with double blaze scribed "1/4 S31 BT", bears S 58° W, 46.8 feet.
- A 10" ponderosa pine with double blaze scribed "1/4 S30 BT", bears N 36 1/2° W, 119.7 feet.
- A 8" ponderosa pine with double blaze scribed "1/4 S30 BT" bears N 09° W, 82.1 feet.

Each new bearing tree has a Umatilla County bearing object sign attached above the upper blaze and a brass washer marked PLS 1639 nailed to the face of the lower blaze.

LOCATION & COMMENTS:

Corner falls on steep East facing hillside +/-150 feet South of fence and +/-200 feet East of break in ground at treeline.

COMPASS DECLINATION: 18° East

Surveyor's Seal

FIRM/AGENCY: William R. Wells, PLS
P.O. Box 1696
Pendleton, Oregon 97801

Witness: William Hanley, PLS 1639
Rodney Lewis, LSIT

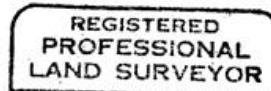

William L. Hanley

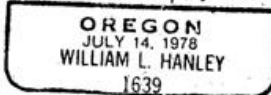

RENEWS 06/30/97

RECEIVED BY

Umatilla County Surveyor

Date 10-95

Rec'd By KK

No. 95-169-B