

CERTIFIED RECORD OF LAND CORNER MONUMENTATION

2-3

History of original corner establishment:

Original survey by Timothy W. Davenport under contract no. 102, 1863,

Set quarter section post, from which

- A Pine, 10 inch in dia. bears S 15°E 29 lks. distant.
- A Pine, 28 inch in dia. bears N 30°W 40 lks. distant.

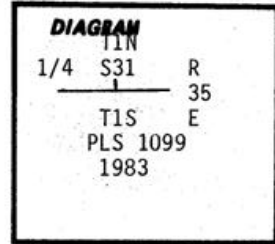

2-3

Description of corner evidence found:

Remains of the original bearing trees: A 14" Ponderosa Pine stump (cut during logging) well decayed, with plain scribing "BT" visible on previously opened blaze, A 28" Ponderosa Pine stump (cut during logging) well decayed, with unhealed and burnt single blaze, no scribing visible.

No evidence remains of the original corner post.

Description of monument and accessories established to perpetuate the original location of this corner:

At the original corner point determined by reference to the original bearing tree stumps we set a 2"x30" galvanized iron pipe 28" in the ground with brass cap, marked: From which:

The original bearing tree stumps previously described:

- A 14" Ponderosa Pine stump bears S 15°E 19.7 ft., (19.1 ft. to face)
- A 28" Ponderosa Pine stump bears N 28°W 27.7 ft., (26.4 ft. to face)

We mark new BT's:

- A 10" Western Larch scribed "1/4 S31 BT" on a double blaze bears N30°E 19.5 ft.
- A 14" Douglas Fir scribed "1/4 S31 BT" on a double blaze bears N 50°W 28.7 ft.

Attached brass washer marked "LS 1099" to lower blaze of new bearing trees.

Staff Compass (20° East Declination) Steel Tape
September 27, 1982 Witnesses: Gary Langlitz
Dick Humiston

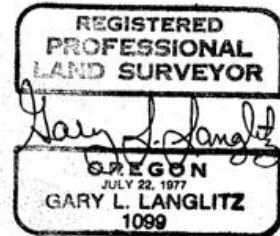

Office of Surveyor County of Hinnatilla
State of Oregon I hereby certify that the within instrument was filed in this office
for record on the 11th day of November, 1983
David L. Krumbein by Betty Cochran
(COUNTY OFFICIAL) (DEPUTY)