

CERTIFIED RECORD OF LAND CORNER MONUMENTATION

2-5

History of original corner establishment:

Original survey by Timothy W. Davenport under contract no. 102, 1863, Set post corner to Sec's. 31 and 32, from which: A Pine 24 inch bears N 10°E 43 links distant. A White Fir 10 inch. dia. bears N 30°W 30 links dist.

Retracement of Willamette Baseline by Currin and Noland under their special contract dated May 4, 1887, Set a 4"x4"x48" post 2 ft. in ground at exact place for original point for cor. to Sec's 31 and 32, marked: SC T1N R35E on N, S32 on E, S31 on W faces, 5 notches on E and 1 notch on W. edges,

From Which: A Pine (original bearing tree) 26 ins. dia. bears N 10°E 43 lks. dist. marked SC T1N R35E S32 BT. A Pine 6 ins. dia. bears S10°W 10 lks. dist. marked SC T1S R35E BT. A Red Fir 24 in. dia. bears N 50°W 103 lks. dist. marked SC T1N R35E S31 BT. The other old BT is fallen. Subdivisions of T1S R35E by J.Currin Et Al, 1887 states: From the corner to Sec's 5,6,31 and 32 on Base Line, I run South between Sec's 5 and 6.

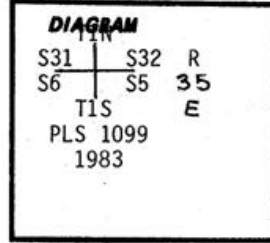

Description of corner evidence found:

A Ponderosa Pine sawn stump, rotted, approx. 26" diameter, with faint scribing "BT" visible on unhealed and burnt single blaze (orig. Davenport NE bearing tree)
 A down and rotted Ponderosa Pine, size and location not definable, with scribing "S BT" visible on open single blaze, (Currin SW bearing tree)

No evidence remains of the Currin NW BT (24" Red Fir) or of the corner monument.

Description of monument and accessories established to perpetuate the original location of this corner:

At the corner position determined at record bearing and distance from the original Davenport NE bearing tree, we set a 2"x30" galvanized iron pipe 28" in the ground with brass cap attached, marked:

From Which:

The original Davenport NE bearing tree, A 26" Ponderosa Pine sawn stump bears N 10°E 28.4 ft. (to face of blaze)

We mark new bearing trees as follows:

A 12" Douglas Fir, scribed "SC T1N R35E S32 BT" on a double blaze bears N 37 1/2°E 58.0 ft.

A 12" White Fir scribed "SC T1N R35E S31 BT" on a double blaze bears N39 1/2°W 68.4 ft.

A 14" Western Larch, scribed "T1S R35E S5 BT" on a double blaze bears S 12°E 7.0 ft. and a 12" Douglas Fir, scribed "T1S R35E S6 BT" on a double blaze bears S 61 1/2°W 19.6 ft.

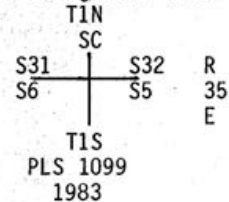

Attached brass washer marked "LS 1099" to lower blaze of new bearing trees. Bearing and horizontal distance measured to center of BT's at ground level.

Staff Compass (20° East Declination) Steel Tape.
 October 4, 1983 Witnesses: Gary Langlitz LS 1099
 Dick Humiston

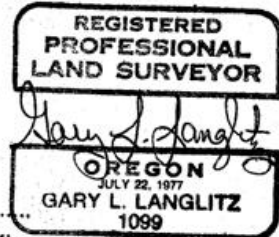

Office of Surveyor County of Washtenaw
 State of Oregon I hereby certify that the within instrument was filed in this office
 for record on the 11th day of November, 1983
David Humiston by Betty Cochran
 (COUNTY OFFICIAL) (DEPUTY)