

Index

File No. V-0125

CORNER RECORD (SEARCH)

(Ref. FSM 7151.4)

Tract or Survey No. \_\_\_\_\_ Cor. No. \_\_\_\_\_

T 1N R. ~~57E~~ 36E

R.D. WALLA WALLA County UMATILLA

Merid. WILLAMETTE

N.F. UMATILLA State OREGON

CORNER DIAGRAM

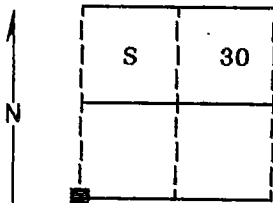

DESCRIBE CORNER MONUMENT FOUND

Found no evidence of the original corner monument.

DESCRIBE BEARING TREES OR OTHER OFFICIAL ACCESSORIES FOUND

Found a 30 inch diameter Ponderosa Pine N5°W, 360 lks, dead, down and rotted with faint scribes visible.

PHOTO IDENTIFICATION DATA

12 616140A 787-58

Photo No. \_\_\_\_\_

Filed At. Ranger Office

Object Ident. Bearing Tree

Ident. By D.I. Griffith

*Signature*

PLANE COORDINATE POSITION DATA

State \_\_\_\_\_ Zone \_\_\_\_\_

X \_\_\_\_\_

Y \_\_\_\_\_

Estab. By \_\_\_\_\_

*Agency*

*Signature*

DESCRIBE CORNER LOCATION RELATIVE TO NEAR-BY FEATURES, ALSO HOW TO REACH CORNER

Corner falls on very steep West face approximately 150 feet below the top of the ridge and approximately 4000 feet North of the end of the 020 road.

Title Surveyor

Division \_\_\_\_\_

Headquarters \_\_\_\_\_

Date 9-19-89 FS-7100-52 (3/68)

*Handwritten signature of D.I. Griffith*

### CORNER RECORD (PERPETUATION)

**MONUMENT: DESCRIBE NEW MONUMENT SET, OR WORK DONE TO PRESERVE EXISTING MONUMENT**

Set a 2½"x30" aluminum pipe with aluminum cap marked as shown:  
 Pipe is set 20 inches in the ground.

T1N	
R36E	R37E
S 25	S 30
S 36	S 31
1989	
OPLS 644	

Raised a mound of stone around monument, 4 ft. base to top of cap.

**ACCESSORIES : DESCRIBE NEW BT'S WITNESS OBJECTS ETC. ESTABLISHED, OR WORK DONE TO PRESERVE EXISTING EVIDENCE**

**New Bearing Tree and Bearing Objects:**

Drove a PK nail in the lower center of a 8'x4' rock face,  
 with BO chiseled below, bears N62°E, 13.87 feet.  
 A 5/8"x20" iron pin with plastic cap marked BGA SURVEY MARKER bears S44°E, 10.40 feet  
 A 1/2"x20" iron pin with plastic cap marked BGA SURVEY MARKER bears S20°W, 9.62 feet  
 A 14 inch diameter Ponderosa Pine bears N6°W, 206.84 feet marked T1N R36E S25 BT  
 Painted a 6 inch red band around all BTs and the rock bearing object. Attached bearing  
 tree signs to all BTs and BOs and land survey monument signs to BTs. Set a steel fence  
 post approximately 5 feet North with 54-9 and 54-2 signs attached.

10

Work Done By D.I. Griffith Title Surveyor Date 9-12-89 State Registration No. OPLS 644  
 or Agency

Certified Cor. Record Prepared? Yes  No  Filed At: Umatilla Co. Surveyor's Office Date 9-89

11

REMARKS

Witness: Jeff Petersen

12

Index File No. V-~~25~~ T. 1N

R. ~~37E~~ W.M.

Tract or Surv. No.

Cor.

13

25

36E

USDA-FOREST SERVICE

Index File No. V-25

CORNER RECORD (SEARCH)

(Ref. FSM 7151.4)

Tract or Survey No. \_\_\_\_\_ Cor. No. \_\_\_\_\_

T IN R. 36E

R.D. WALLA WALLA County UMATILLA

Merid. WILL

N.F. UMATILLA State OREGON

CORNER DIAGRAM

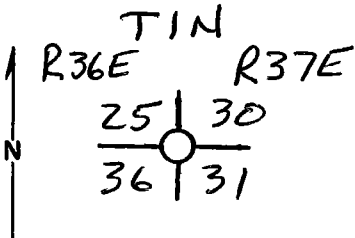

DESCRIBE CORNER MONUMENT FOUND

NONE

DESCRIBE BEARING TREES OR OTHER OFFICIAL ACCESSORIES FOUND

NONE - I DID NOT FIND THE EVIDENCE RECOVERED BY BILL MOORE IN 1977, I MAY HAVE BEEN TOO FAR WEST WITH MY SEARCH AREA.

PHOTO IDENTIFICATION DATA

Photo No. \_\_\_\_\_  
Filed At. \_\_\_\_\_  
Object Ident. \_\_\_\_\_  
Ident. By \_\_\_\_\_

Signature

PLANE COORDINATE POSITION DATA

State \_\_\_\_\_ Zone \_\_\_\_\_  
X \_\_\_\_\_  
Y \_\_\_\_\_  
Estab. By \_\_\_\_\_

Agency

Signature

Title

Division

Headquarters

Date

FS-7100-52 (3/68)

Dennis L. Gaylord

LS 1636

S.O.

6-88

**CORNER RECORD (PERPETUATION)**

**MONUMENT: DESCRIBE NEW MONUMENT SET, OR WORK DONE TO PRESERVE EXISTING MONUMENT**

9

**ACCESSORIES : DESCRIBE NEW BT'S WITNESS OBJECTS ETC. ESTABLISHED, OR WORK DONE TO PRESERVE EXISTING EVIDENCE**

10

Work Done By \_\_\_\_\_ Title \_\_\_\_\_ Date \_\_\_\_\_ State Registration No. or Agency \_\_\_\_\_

Certified Cor. Record Prepared ? Yes No Filed At: \_\_\_\_\_ Date \_\_\_\_\_

11

**REMARKS**

12

Index File No. T. R. M. Tract or Surv. No. Cor. 13

**CORNER RECORD (SEARCH)**

(Ref. FSM 7151.4)

Tract or

Survey No. 7

No. V-1

Index  
File No. V-1

T IN R. 37E

R.D. Pendleton County Umatilla

Merid. Willamette

N.F. Umatilla State Oregon

**CORNER DIAGRAM**

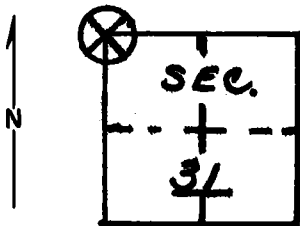

**DESCRIBE CORNER MONUMENT FOUND**

None.

**DESCRIBE BEARING TREES OR OTHER OFFICIAL ACCESSORIES FOUND**

Twin down p. pine trees on top of ridge. One tree has faint line blaze on it. The other one has what appears to be a scribed B; trees have been burned.

**PHOTO IDENTIFICATION DATA**

Photo No. \_\_\_\_\_  
Filed At. \_\_\_\_\_  
Object Ident. \_\_\_\_\_  
Ident. By \_\_\_\_\_  
*Signature*

**DESCRIBE CORNER LOCATION RELATIVE TO NEAR-BY FEATURES, ALSO HOW TO REACH CORNER**

Open hillside to south. Location is on steep west slope.

**PLANE COORDINATE POSITION DATA**

State \_\_\_\_\_ Zone \_\_\_\_\_  
X \_\_\_\_\_  
Y \_\_\_\_\_  
Estab. By \_\_\_\_\_  
*Agency*

Signature  
Bill Moore

Title  
Eng. Tech.

Division \_\_\_\_\_

Headquarters \_\_\_\_\_

Date

10/5/77

7100-52-(3/68)

## CORNER RECORD (PERPETUATION)

---

 MONUMENT: DESCRIBE NEW MONUMENT SET, OR WORK DONE TO PRESERVE EXISTING MONUMENT
 

---



---

 ACCESSORIES: DESCRIBE NEW BT'S WITNESS OBJECTS ETC. ESTABLISHED, OR WORK DONE TO PRESERVE EXISTING EVIDENCE
 

---



---

 Work Done By \_\_\_\_\_ Title \_\_\_\_\_ Date \_\_\_\_\_ State Registration No. \_\_\_\_\_  
 or Agency \_\_\_\_\_
 

---



---

 Certified Cor. Record Prepared ? Yes No Filed At \_\_\_\_\_ Date \_\_\_\_\_
 

---

## REMARKS

---

 Index File No. T. R. M. Tract or Surv. No. Cor.
 

---