

Index

File No. 2-5

CORNER RECORD (SEARCH)

(Ref. FSM 7151.4)

Tract or Survey No. _____ Cor. No. _____

T 1N R. 36E

R.D. _____ County _____

Merid. _____

N.F. _____ State _____

CORNER DIAGRAM

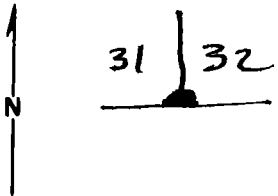

DESCRIBE CORNER MONUMENT FOUND

*Brass Cap set by BLM
1982*

DESCRIBE BEARING TREES OR OTHER OFFICIAL ACCESSORIES FOUND

PHOTO IDENTIFICATION DATA

Photo No. _____
Filed At. _____
Object Ident. _____
Ident. By _____

Signature

PLANE COORDINATE POSITION DATA

State _____ Zone _____
X _____
Y _____
Estab. By _____

Agency

Signature

Title

Division

Headquarters

Date

CORNER RECORD (PERPETUATION)

MONUMENT : DESCRIBE NEW MONUMENT SET, OR WORK DONE TO PRESERVE EXISTING MONUMENT

ACCESSORIES : DESCRIBE NEW BT'S WITNESS OBJECTS ETC. ESTABLISHED, OR WORK DONE TO PRESERVE EXISTING EVIDENCE

Work Done By _____ **Title** _____ **Date** _____ **State Registration No.** _____
or Agency _____

Certified Cor. Record Prepared ? Yes No **Filed At:** _____ **Date** _____

REMARKS

Index File No. T. R. M. **Tract or Surv. No.** **Cor.**

Index
File No. Z - 5

CORNER RECORD (SEARCH)

(Ref. FSM 7151.4)

Tract or Survey No. _____
Cor. No. Z - 5

44
80

T 1 N R. 36E
Merid. Willamette

R.D. Pendleton County Umatilla
N.F. Umatilla State Oregon

CORNER DIAGRAM

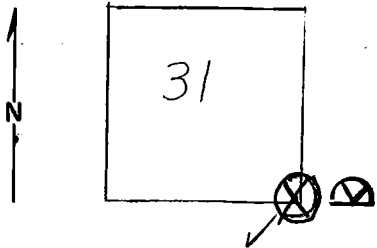

DESCRIBE CORNER MONUMENT FOUND

None found.

DESCRIBE BEARING TREES OR OTHER OFFICIAL ACCESSORIES FOUND

Ponderosa pine BT (7' high snag) bears S80°W 83 LKs from corner; DBH is 26".
No evidence of other BTs.

PHOTO IDENTIFICATION DATA

Photo No. EQO(7/19/66)2-283
Filed At. _____
Object Ident. P. Pine
Ident. By _____
Signature

DESCRIBE CORNER LOCATION RELATIVE TO NEAR-BY FEATURES, ALSO HOW TO REACH CORNER

Found corner by walking east of the Crow Ridge Road where the baseline crosses the road. Corner is about 300 ft. below top of Crow Ridge and is in a clearing.

PLANE COORDINATE POSITION DATA

State _____ Zone _____
X _____
Y _____
Estab. By _____
Agency



Signature
KEN MAGOON

Title
ENG. ALDE

Division
USFS

Headquarters
UMATILLA N.E. SO (9/2/69)

Date
7100-52 (3/68)

7100-52 (3/68)

CORNER RECORD (PERPETUATION)

MONUMENT: DESCRIBE NEW MONUMENT SET, OR WORK DONE TO PRESERVE EXISTING MONUMENT

ACCESSORIES : DESCRIBE NEW BT'S WITNESS OBJECTS ETC. ESTABLISHED, OR WORK DONE TO PRESERVE EXISTING EVIDENCE

Posted "BT" and attention "signs".
 Flagged (red) and painted (red) BT.
 Chained west to Crow Ridge Rd. approx. 8 1/2 chains; Posted corner location tag.

Work Done By Marvin Benson Title Eng. Aide Date 8/17/69 State Registration No. USFS
 or Agency _____

Certified Cor. Record Prepared ? Yes No Filed At: _____ Date _____

REMARKS

Pin prick on photo is Ponderosa Pine which bears N48°E, 43 LKs of southwest BT, DBH is 6".
 Used USGS Duncan Quadrangle map (1964).

Index File No. Z-5 T. _____ R. _____ M. _____ Tract or Surv. No. _____ Cor. _____