

OREGON CORNER RESTORATION FORM

Section 14 Township 1S Range 32E
 County Umatilla Date: September 13, 2007

Corner Designation: 1S32R21

Corner to sections 23, 24, 25, and 26, T1S, R32E,
 W.M., Umatilla County, Oregon.

Condition Report Only
 Not found
 Remonumented
 Unrecorded
 Surveyed in
 Referenced out

Previous Renewals / Surveys, etc.

Corner originally set by Daniel Chaplin under contract No. 107 dated September 21, 1864. His record reads: Set stone, 14x8x6 for Cor. to Secs. 23, 24, 25 & 26.

Monument and Accessories found: (condition and source)

The original stone, lying on its side in a stone mound in a north - south fence line. The mound also had a steel post from the fence driven in it.

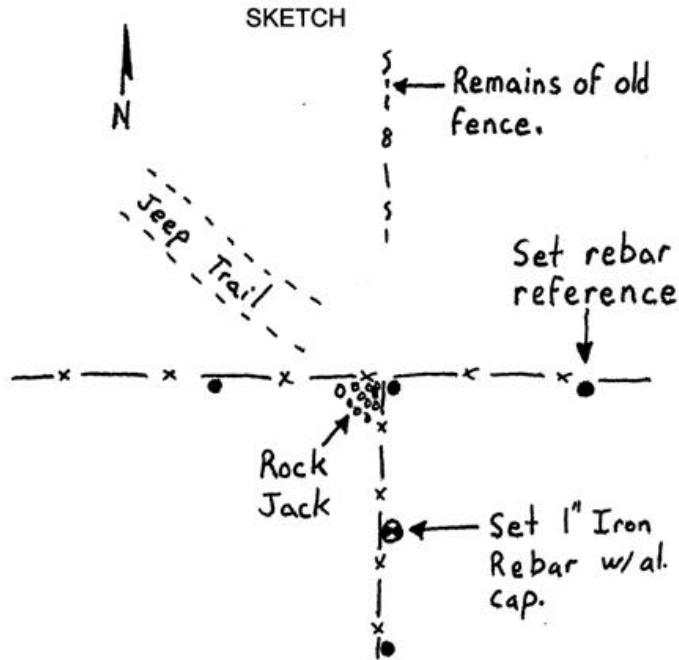
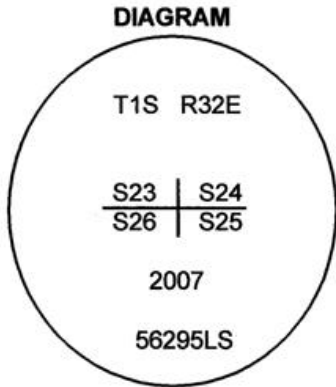

MONUMENT (S) AND ACCESSORIES SET (Procedures and Description)

I set a 1" x 24" iron rebar with a 2" aluminum cap stamped as shown in the diagram above at the position of the original stone. I buried the stone on the north side of the rebar.

For references, I set four, 5/8" by 12" rebars with 1 1/8" orange plastic caps attached, stamped WTS and 56295LS as described below:

- an iron rebar bears N42°01'58"W, 59.36 feet ;
- an iron rebar bears N0°12'25"W, 43.36 feet;
- an iron rebar bears N46°14'29"E, 63.82 feet;
- an iron rebar bears S0°27'47"E, 19.29 feet;

The monument and references were tied using a Trimble R7/R8 RTK GPS.

Location and comments

Compass Declination

Surveyors Seal

RECEIVED BY:

Umatilla County Surveyor

Date: 10-07

Rec'd By: KK

No. 07-268-B

Firm / Agency
 Witness Tree Surveying
 Address
 P.O. Box G
 Pilot Rock, Or. 97868
 Party Chief
 Stephen K, Haddock

REGISTERED
 PROFESSIONAL
 LAND SURVEYOR

Stephen K. Haddock
 OREGON
 JULY 9, 2001
 STEPHEN K. HADDOCK
 56295LS

RENEWAL DATE 6-30-09