

**OREGON CORNER RELOCATION FORM**

Section 3 Township 1S Range 34E  
 County Umatilla Date: November 5, 1997

Corner Designation: 1S34A15

North quarter corner to section 3, T1S, R34E W.M.

Condition Report Only

- Not found
- Remonumented
- Unrecorded
- Surveyed in
- Referenced out

Previous Renewals / Surveys, etc.  
 Corner not previously set.

Monument and Accessories found: ( condition and source )  
 Found nearby K tag on fence. Found nearby mound of stone of unknown origin.

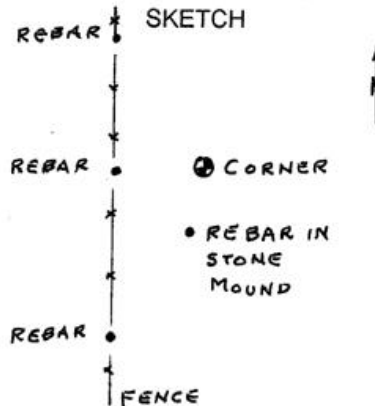
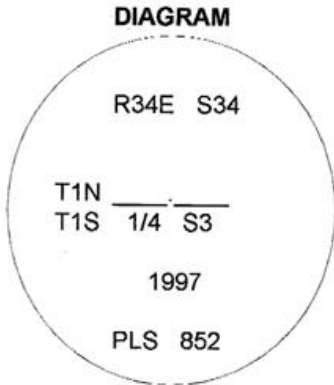

**MONUMENT (S) AND ACCESSORIES SET (Procedures and Description)**

Set a 1 1/4" x 30" Galvanized Iron Pipe with a 2 1/2" brass cap stamped as shown in the diagram above at the position of the surveyed point. The cap is 6" above the surface of the ground with a collar of stone.

For references, I set four 5/8" by 24" rebars with 1.25" red plastic caps stamped ORLS 852 and WALS 13922 as described below:

- a rebar bears S26°14'W, 59.40 feet under an existing fence.
- a rebar bears S11°36'W, 19.44 feet in an existing stone mound.
- a rebar bears N87°49'W, 25.02 feet under an existing fence.
- a rebar bears N29°30'W, 48.87 feet under an existing fence.

Monument and reference locations were surveyed with theodolite from two existing brass caps at south 1/4 and southeast corners of Section 34, T. 1 N., R. 34 E., W.M.

The bearings and distances are true

Location and comments

Compass Declination

Surveyors Seal

RECEIVED BY:  
Umatilla County Surveyor  
 Date: 11-97  
 Rec'd By: KR  
 No. 97-217-B

Firm / Agency  
 Haddock Surveying  
 Address  
 P.O. Box 1574  
 Pendleton, Or. 97801  
 Party Chief  
 David L. Haddock  
 Witness  
 Stephen K. Haddock

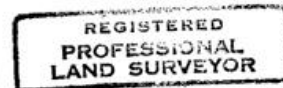

*David L. Haddock*

