

CERTIFIED RECORD OF LAND CORNER MONUMENTATION

F-25

History of original corner establishment:

Original survey by Currin and Noland under special contract, 1887,

- Set a post 48x4x4 ins. 2 ft. in the ground for cor. to sec's. 1,6,7 and 12 mkd. T1S S1 on NW, R34E S12 on SW S6 on NE, R35E S7 on SE faces with 5 notches on S and 1 on N. edges, from which:
- A Fir, 12 ins. in diam. bears S 80°E 21 links dist. marked T1S R35E S7 BT.
- A Pine 16 ins. in diam. bears N 80°W 21 links dist. marked R34E S1 BT.

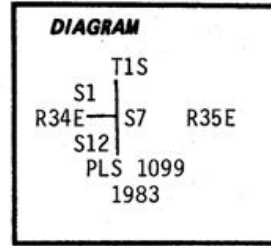

No other trees in limits. Pits impractical.

Closing corner established for Sec. 6 and 7 T1S R35E by Currin and Noland, 1887.

Description of corner evidence found:

Found a rotted Douglas Fir stump, 18" diam. flush in ground and pieces of scribed wood, scribing "R35E" and various reverse scribing visible located near base of bearing tree.

No evidence remains of the corner post or NW bearing tree.

Description of monument and accessories established to perpetuate the original location of this corner:

At the corner point established record bearing and distance from the original SE bearing tree, we set a 2"x30" galvanized iron pipe, 26" in the ground along the east side of a N-S logging road and in a N-S fence line with brass cap marked: T1S
From which:

The remains of the original SE bearing tree previously described bears S80°E 13.9 ft. and new BT's

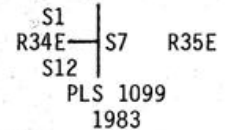

An 8" Douglas Fir, scribed "T1S R34E S1 BT" on a double blaze bears N35 1/2°W 30.8 ft. and a 14" Douglas Fir, scribed "X RP BT" on a double blaze bears N 77 1/2°W 68.9 ft.

Attached brass washer marked "LS 1099 to lower blaze of new BT's.

Staff Compass (19 1/2° East Declination) Steel Tape
Sept. 27, 1983

Witnesses: Gary Langlitz
Dick Humiston

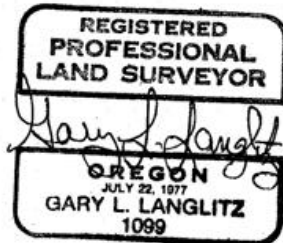

Office of Surveyor County of Shastilla
 State of Oregon I hereby certify that the within instrument was filed in this office
 for record on the 11th day of November, 1983
DAVID KRUMBEIN by Betty Cochran
 (COUNTY OFFICIAL) (DEPUTY)

☆ GPO-7503-R
83-183-R