

R-21

OREGON CORNER RESTORATION FORM

Section 26 Township 1 S Range 35 E

County Umatilla Date 9-25-91

Corner Designation

SECTION CORNER
COMMON TO
SECTIONS 23, 24, 25 & 26

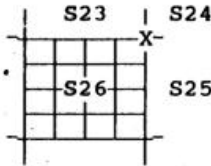

- Condition Report Only
- Not Found
- Renewed
- Unrecorded
- Surveyed In
- Referenced Out

Previous Renewals/Surveys, etc.

Surveyed by Rufus S. Moore G.L.O. Contract #451 June 12, 1882.
USDA FOREST SERVICE index file No. R-21 Dennis Gaylord P.L.S. 1636
6-25-81.

B.L.M. 1984.

OREGON STATE PARKS 1991.

Monument(s) & Accessories Found: (Condition and Source)

10" TAMARACK with tag marked "N 24 1/2° W - 29 1/2 Lks. Posted by
L.H. 5-84" with partially healed scribe "T 1 S R 35 E SEC 25 BT"
bears S 25° E 19.1' [29 1/2 Lks. = 19.5'].

30" FIR with tag marked "N 58° E 41 Lks. 5-85" with scribe 9" deep
scribed "5M" T 1 S, R 35 E SEC 26 bears S 58° W 26.9'
[41 Lks. = 27.1'].

16" FIR with tag marked "S 12 1/2° E - 34 Lks. 5-84 posted by L.H."
FIR scribed "T 1 S R 35 E S23 BT" bears N 12° W 22.0'
[34 Lks. = 22.4'].

18" FIR with tag marked "S 27 1/2° W - 13 1/2 Lks. 5-84"
FIR scribed "T 1 S R 35 E S24 BT" bears N 29° E 8.2'
[13 1/2 Lks. = 8.9'].

Monument Detail

3 1/4" Diam. BRASS CAP
on 2 1/2" Diam. Galvanized Pipe

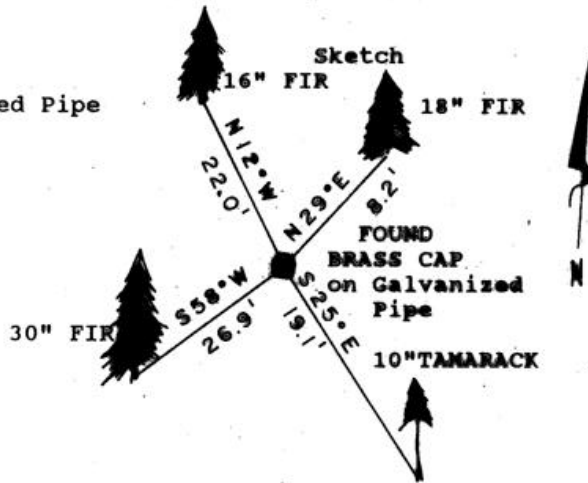

Monument Set (Procedures and Description)
NONE

New Accessories
NONE

Location & Comments
TIES TO BEARING TREES
BY E.D.M. PENTAX 10D
Calculated Bearings
from adjusted
traverse.

Compass Declination
by: N.A.
Oregon State Parks
& Recreation Department
525 Trade Street, S.E.
Salem, OR 97310

Surveyor's Seal



RECEIVED BY
Umatilla County Surveyor
Date 12-91
Rec'd By KK
No. 91-103 B

Barty Chief: Billy J.W. Hermann
Notes: Dean Timmerman
Witness: Billy J.W. Hermann
Harold Hanson