

REPORT ON CONDITION OF FOUND GOVERNMENT CORNER

R-24

Robert Butler

December 11, 1996

Umatilla County

Description of Corner as Set:

Corner was set in 1984 by Lawrence D. Holmes, BLM Cadastral surveyor, as part of a dependent resurvey dated September 22, 1983, group number 1184, Oregon.

The field notes state: "Set an iron post, 30" long, 2½" diam., with magnetic, plastic breakaway base, 26" in the ground, with brass cap marked E 1/16 S 24

S 25

1984

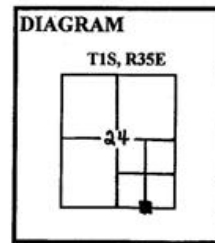

From which

A fir, 13" diam., bears N 27½°E, 14½ Lks. dist., marked E 1/16 S24 Bt.

A fir, 10" diam., bears S 3 3/4° W, 11 Lks. dist., marked E 1/16 S25 Bt.

Description of Corner Evidence Found:

Found 3" BLM brass cap on 2½" galvanized steel pipe protruding 6" out of ground in good condition with fence post 2'± north of corner from which:

A 14" white fir bears N 27½°E, 14½ links dist. with partially healed blaze.

A 12" white fir bears S 3 3/4° W, 11 Links dist. with partially healed blaze.

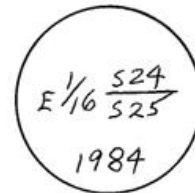

RECEIVED BY
 Umatilla County Surveyor
 Date 12-96
 Rec'd By KK
 No. 96-194-B

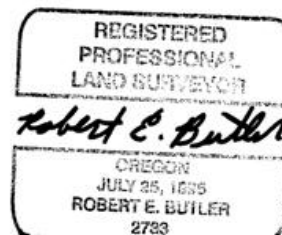

Expires 12/31/97
 Oregon Dept. of Transportation
 3012 Island Avenue
 La Grande, OR 97850

R-24