

USDA-FOREST SERVICE

Index  
File No. V-13

CORNER RECORD (SEARCH)

(Ref. FSM 7151.4)

Tract or  
Survey No. \_\_\_\_\_ Cor.  
No. \_\_\_\_\_

T 15 R. 35E

R.D. UKIAH County UMATILLA

Merid. WILL

N.F. UMATILLA State OREGON

CORNER DIAGRAM

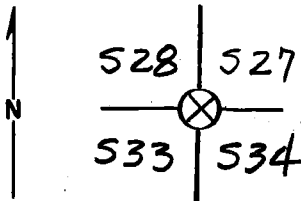

DESCRIBE CORNER MONUMENT FOUND

NONE

DESCRIBE BEARING TREES OR OTHER OFFICIAL ACCESSORIES FOUND

ORIGINAL B.T. SET BY RUFUS MOORE IN 1882;  
A DECAYED SAWN PINE STUMP W/ UNHEALED CHARRED  
BLAZE, FRAGMENTARY SCRIBING VISIBLE, BEARS S18°E,  
76 1/2 ft.

BT'S SET BY M. BUCHANAN IN 1895;  
A 14" SAWN TAMARACK STUMP - I OPEN & FIND AXE  
FACE & HORIZONTAL AXE MARKS BEHIND 0" OF GROWTH.

DESCRIBE CORNER LOCATION RELATIVE TO NEAR-BY FEATURES, ALSO HOW TO REACH CORNER  
STUMP IS CUT BELOW SCRIBING, BEARS N22°E, 11 1/2 ft.

A DOWN & DECAYED TAMARACK WITH DOUBLE UNHEALED  
BLAZES SCRIBED "T15 R35E 533 BT" BEARS  
S46°30'W, 15 1/2 ft.

NO EVIDENCE OF OTHER BT'S REMAINS.  
I PLACED A "K" TAG ON ROAD 110' SOUTH OF CORNER.

PHOTO IDENTIFICATION DATA

Photo No. \_\_\_\_\_  
Filed At. \_\_\_\_\_  
Object Ident. \_\_\_\_\_  
Ident. By \_\_\_\_\_

Signature

PLANE COORDINATE POSITION DATA

State \_\_\_\_\_ Zone \_\_\_\_\_  
X \_\_\_\_\_  
Y \_\_\_\_\_  
Estab. By \_\_\_\_\_

Agency

Signature Dennis L. Laylord

Title PLS 1636 Division \_\_\_\_\_ Headquarters \_\_\_\_\_ Date \_\_\_\_\_

7100-52-(3-'68)

2

7

4

5

**CORNER RECORD (PERPETUATION)**

**MONUMENT : DESCRIBE NEW MONUMENT SET, OR WORK DONE TO PRESERVE EXISTING MONUMENT**

**ACCESSORIES : DESCRIBE NEW BT'S WITNESS OBJECTS ETC. ESTABLISHED, OR WORK DONE TO PRESERVE EXISTING EVIDENCE**

**Work Done By** \_\_\_\_\_ **Title** \_\_\_\_\_ **Date** \_\_\_\_\_ **State Registration No.**  
**or Agency** \_\_\_\_\_ 10

**Certified Cor. Record Prepared ?** Yes  No  **Filed At:** \_\_\_\_\_ **Date** \_\_\_\_\_ 11

**REMARKS**

**Index File No.** \_\_\_\_\_ **T.** \_\_\_\_\_ **R.** \_\_\_\_\_ **M.** \_\_\_\_\_ **Tract or Surv. No.** \_\_\_\_\_ **Cor.** \_\_\_\_\_ 12