

USDA-FOREST SERVICE

Index

File No. A-01

CORNER RECORD (SEARCH)

(Ref. FSM 7151.4)

Tract or

Survey No. \_\_\_\_\_

Cor.

No. \_\_\_\_\_

T 15 R. 36E

R.D. WALLA WALLA County UMATILLA

Merid. WILLAMETTE

N.F. UMATILLA State OREGON

CORNER DIAGRAM



DESCRIBE CORNER MONUMENT FOUND

FND BLM BRASS CAP RISING 6" ABOVE GROUND.

FND 2 1/2" ALUMINUM CAPPED ALUMINUM PIPE BY U.S.F.S.  
RISING 4" ABOVE GROUND 3.8 FT. NORTH OF BLM CORNER.  
ALUM. CORNER STAMPED A.M.

DESCRIBE BEARING TREES OR OTHER OFFICIAL ACCESSORIES FOUND

14" W. FIR BEARS S52°W, 29.0 FT.,  
B&S T1R35E S1 CC BT.

10 1/2" W. FIR BEARS S15 1/2°E, 19.8 FT.,  
B&S T1R36E S6 CC BT.

PHOTO IDENTIFICATION DATA

Photo No. \_\_\_\_\_

Filed At. \_\_\_\_\_

Object Ident. \_\_\_\_\_

Ident. By \_\_\_\_\_

*Signature*

PLANE COORDINATE POSITION DATA

State \_\_\_\_\_ Zone \_\_\_\_\_

X \_\_\_\_\_

Y \_\_\_\_\_

Estab. By \_\_\_\_\_

*Agency*

DESCRIBE CORNER LOCATION RELATIVE TO NEAR-BY FEATURES, ALSO HOW TO REACH CORNER

3032 "Y" S AT WEST LINE OF S31. TAKE RIGHT  
"Y" FROM 3032 SOUTHEASTERLY 1/2 MI. — CROSSES  
POSTED LINE. CORNER IS 150 FT. EAST.

*Signature*  
B. Sullivan

Title  
LS 1848

Division

Headquarters

Date

5-31-85

7100-52-(3-68)

CORNER RECORD (PERPETUATION)

MONUMENT: DESCRIBE NEW MONUMENT SET, OR WORK DONE TO PRESERVE EXISTING MONUMENT

NONE

ACCESSORIES: DESCRIBE NEW BT'S WITNESS OBJECTS ETC. ESTABLISHED, OR WORK DONE TO PRESERVE EXISTING EVIDENCE

SET STEEL FENCE POST 3 FT. EAST OF CORNER.  
ATTACHED SIGNS TO BT'S & POST. PAINTED RED BANDS

Work Done By B.A. SUTTON Title SURVEYOR Date 5-31-85 State Registration No. LS 1848  
or Agency

Certified Cor. Record Prepared? Yes No  Filed At:

Date

REMARKS

Index File No.

A-01

T. 15

R. 36E W.M.

Tract or Surv. No.

Cor.

CC 15

Index  
File No. A-1

CORNER RECORD (SEARCH)

(Ref. FSM 7151.4)

Tract or Survey No. A 1 Cor. No. Sec 1

T 1 S 36 E

R.D. Pendleton County Umatilla

Merid. Willamette

N.F. Umatilla State Oregon

CORNER DIAGRAM

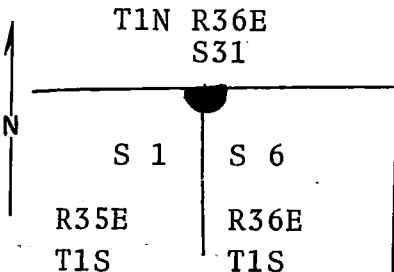

DESCRIBE CORNER MONUMENT FOUND

Set brass cap summer 1972. See reverse side.

● *See mon. file*

DESCRIBE BEARING TREES OR OTHER OFFICIAL ACCESSORIES FOUND

Found an 18" tamarack with all scribing visible, bearing S74°E 15.8 ft. dist. from the corner position.  
Found a 40" fir down and rotten with reversed scribing clearly visible bearing S24°W 27 ft. dist. from the corner position.

PHOTO IDENTIFICATION DATA

Photo No. \_\_\_\_\_  
Filed At. \_\_\_\_\_  
Object Ident. \_\_\_\_\_  
Ident. By \_\_\_\_\_

*Signature*

PLANE COORDINATE POSITION DATA

State \_\_\_\_\_ Zone \_\_\_\_\_  
X \_\_\_\_\_  
Y \_\_\_\_\_  
Estab. By \_\_\_\_\_  
*Agency*

DESCRIBE CORNER LOCATION RELATIVE TO NEAR-BY FEATURES, ALSO HOW TO REACH CORNER

Signature

Title

Division

Headquarters

Date

7100-52 (3/68)

4

5

CORNER RECORD (PERPETUATION)

MONUMENT: DESCRIBE NEW MONUMENT SET, OR WORK DONE TO PRESERVE EXISTING MONUMENT

Set a 30x2½" iron pipe marked as shown, 24" in the ground, for the closing corner to sec. 1 & 6. From which New BTs:

ACCESSORIES : DESCRIBE NEW BT'S WITNESS OBJECTS ETC. ESTABLISHED, OR WORK DONE TO PRESERVE EXISTING EVIDENCE

A fir 14" dia. bears N36°E 43 ft. dist. marked T1N R36E S31 BT.

A fir 8" dia. bears S32°E 16.2 ft. dist. marked T1S R36E S6 BT.

A spruce 14" dia. bears S24°W 49.5 ft. dist. marked T1S R35E S1 CC BT.

Distances taken to a brass washer in the blaze of each tree.

Set a steel fence post approx. 5 ft. East from corner with Forest Boundary sign attached. Used steel tape & magnetic compass with declination = 20°E.

Work Done By D. M. Ferguson Title Land Surveyor Date 7/12/68 State Registration No. 848  
or Agency

Certified Cor. Record Prepared ? Yes No Filed At: Umatilla Co. Courthouse Date 11/16/72

REMARKS

Form 874-9—Revised May, 1918

U. S. Department of Agriculture  
FOREST SERVICE

Umahilla NATIONAL FOREST

CORNERS OF THE PUBLIC SURVEY

T. 18 R. 36E W. Mer.

Section Corner ~~common to Sections~~

North west cor. of 6

Corner consists of a could not be (not) in place  
State condition found.

Dimensions above ground \_\_\_\_\_ inches.

Sketch grooves, letters, figures, or notches, on proper face or edge.

CARDINAL POSITION

DIAGONAL POSITION

|  |  |  |  |
|--|--|--|--|
|  |  |  |  |
|  |  |  |  |

|  |  |  |  |
|--|--|--|--|
|  |  |  |  |
|  |  |  |  |

N W S E

NW SW SE NE

Mound of \_\_\_\_\_ is located \_\_\_\_\_

Pits are located \_\_\_\_\_

Sketch markings of Bearing Trees (or Rocks) in proper box and fill blanks below, giving bearings from Corner to Trees and Distances in Links.

|                   |     |            |
|-------------------|-----|------------|
| Not a chip<br>any | T15 | Deal stump |
|                   | R36 |            |
|                   | 56  |            |
|                   | BT  |            |

Species WF WL

Diameter 32 28 in

Bearing S55W S60E

Distance 20 ft 15 ft

Do you believe this to be a genuine Land Office Corner? Yes

If not, why? Location of corner  
could be set within 20 ft.

Oct 29/47 (Date) W. J. Tucker (Signature)  
Dist Ranger (Title)

(Make sketch of topography near Corner)

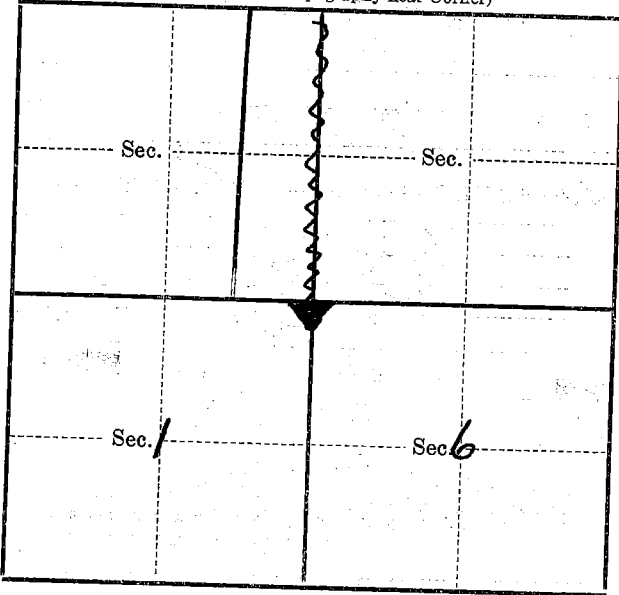

Metal Location Poster is on a *W.F.*  
 tree *.16* inches diameter, on the *North*  
 side of *Corner*  
 from which this Corner bears *South 10° E*  
*30 ft.* ~~chain~~ distant.

Give any further facts which will aid in finding this  
 Corner again.

*Corner shown on  
 Pendleton District aerial  
 photographs.*