

Index
File No. F-08

CORNER RECORD (SEARCH)
(Ref. FSM 7151.4)

Tract or
Survey No. _____
Cor.
No. _____

T 1S R. 36E

R.D. WALLA WALLA County UMATILLA

Merid. WILLAMETTE

N.F. UMATILLA State OREGON

CORNER DIAGRAM

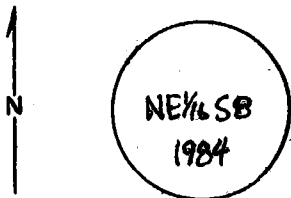

DESCRIBE CORNER MONUMENT FOUND

3 1/4 BLM BRASS CAP ON 2 1/2" IRON PIPE
RISING 10" IN MOUND OF STONES

DESCRIBE BEARING TREES OR OTHER OFFICIAL ACCESSORIES FOUND

19 1/2" DOUG FIR BLAZED & SCRIBED NE 1/4 SB BT
BEARS N 79° E ~ 29 LKS - 19.1 FT
14 1/2" DOUG FIR BLAZED & SCRIBED NE 1/4 SB BT
BEARS S 6 1/2° W 46 LKS - 30.4 FT

PHOTO IDENTIFICATION DATA

Photo No. _____
Filed At. _____
Object Ident. _____
Ident. By _____
Signature

DESCRIBE CORNER LOCATION RELATIVE TO NEAR-BY FEATURES, ALSO HOW TO REACH CORNER

FOLLOW HORSE HEAVEN RIDGERD (3030090)
TO END - GO SW DOWN CENTER OF DRAW
1/4 MILE TO CORNER

PLANE COORDINATE POSITION DATA

State _____ Zone _____
X _____
Y _____
Estab. By _____
Agency

Signature
B. Sutton

Title
LS 1848

Division

Headquarters

Date
7-85

CORNER RECORD (PERPETUATION)

MONUMENT: DESCRIBE NEW MONUMENT SET, OR WORK DONE TO PRESERVE EXISTING MONUMENT

NONE

ACCESSORIES : DESCRIBE NEW BT'S WITNESS OBJECTS ETC. ESTABLISHED, OR WORK DONE TO PRESERVE EXISTING EVIDENCE

SET STEEL FENCE POST 4' NORTH
ATTACHED SIGNS TO POST & BT'S. PAINTED RED BANDS.

Work Done By. B.A. SUTTON Title SURVEYOR Date 7-85 State Registration No. LS 1848
or Agency

Certified Cor. Record Prepared ? Yes No Filed At:

Date

REMARKS

Index File No. F-08 T. 15 R. 36E M. WILLAMETTE Tract or Surv. No.

Cor. NE 1/4 S8