

U. S. Department of Agriculture  
FOREST SERVICE

Umatilla NATIONAL FOREST

CORNERS OF THE PUBLIC SURVEY

T. 1 S R. 36 E W. Mer.

Sec 12, 13 Corner common to Sections along Range line and

Corner consists of a wooden post in place  
State condition Fair & Rocked up around post

Dimensions above ground \_\_\_\_\_ inches.

Sketch grooves, letters, figures, or notches, on proper face or edge.

CARDINAL POSITION \_\_\_\_\_ DIAGONAL POSITION \_\_\_\_\_

<u>scribing</u>	<u>the post</u>	<u>but not distinct</u>				
<u>enough to</u>	<u>set out.</u>	<u>Post was</u>	<u>lying on</u>			
<u>ground.</u>	<u>Set it</u>	<u>up and</u>	<u>rocked it</u>	<u>up</u>		
N	W	S	E	NW	SW	SE NE

Mound of \_\_\_\_\_ is located \_\_\_\_\_

Pits are located \_\_\_\_\_

Sketch markings of Bearing Trees (or Rocks) in proper box and fill blanks below, giving bearings from Corner to Trees and Distances in Links.

<u>needs</u>			
<u>chopping</u>			
<u>out</u>			

Species y.P.  
Diameter 30"  
Bearing S29W  
Distance 35 feet

Do you believe this to be a genuine Land Office Corner? yes

If not, why? \_\_\_\_\_

Bernard Lee  
(Signature)

Aug 24, 1921  
(Date)

J. R. E.  
(Title)

T. 12 R. 36 E. Mer.

(Make sketch of topography near Corner)

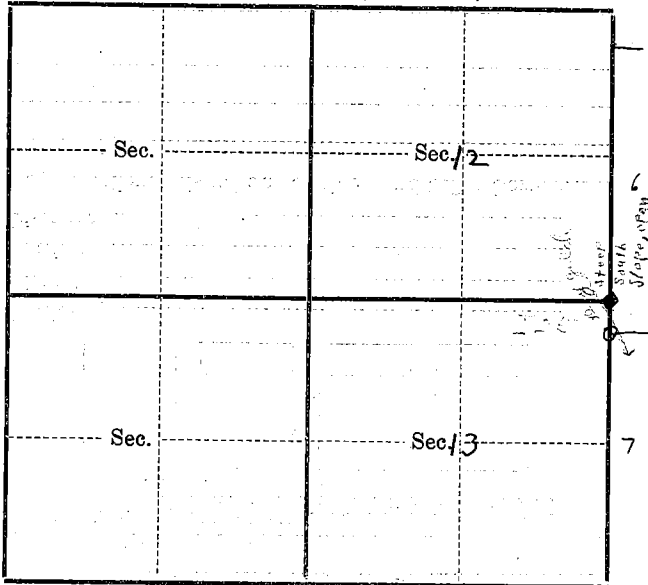

Metal Location Poster is on a Bearing  
tree 30 inches diameter, on the  
side of N.E. side of tree  
from which this Corner bears  
\_\_\_\_\_ chains distant.

Give any further facts which will aid in finding this  
Corner again.

This corner is 1/2 mile south  
of 1/4 corner near the Camp.  
Metal poster on trail about one  
chain east of old cabin is about  
38 chains north of this corner

Index  
File No. J-25  
T TS R. 36E  
Merid. Willamette

**CORNER RECORD (SEARCH)**

(Ref. FSM 7151.4)

R.D. Walla Walla County Umatilla  
N.F. Umatilla State Oregon

Tract or  
Survey No. \_\_\_\_\_  
Cor.  
No. \_\_\_\_\_

**CORNER DIAGRAM**



T1S T1S  
R37E  
S12  
S13 S7  
R36E  
1972  
PLS 848

**DESCRIBE CORNER MONUMENT FOUND**

Found  $2\frac{1}{2}$ " galvanized iron pipe with 3" brass cap marked as shown in diagram.  
See Certified Land Record no. H-151-R.

**DESCRIBE BEARING TREES OR OTHER OFFICIAL ACCESSORIES FOUND**

A 16" ponderosa pine bears  $N36\frac{1}{4}^{\circ}W-78.8$  feet, with healed blaze. A 33" ponderosa pine bears  $S29\ 3/4^{\circ}W-37.2$  feet, with scribing visible. An 18" ponderosa pine bears  $S76^{\circ}E-48.8$  feet, with healed blaze.

**PHOTO IDENTIFICATION DATA**

Photo No. \_\_\_\_\_  
Filed At. \_\_\_\_\_  
Object Ident. \_\_\_\_\_  
Ident. By \_\_\_\_\_  
*Signature*

**PLANE COORDINATE POSITION DATA**

State \_\_\_\_\_ Zone \_\_\_\_\_  
X \_\_\_\_\_  
Y \_\_\_\_\_  
Estab. By \_\_\_\_\_  
*Agency*

**DESCRIBE CORNER LOCATION RELATIVE TO NEAR-BY FEATURES, ALSO HOW TO REACH CORNER**

Corner falls on steep southwesterly slope, follow posted line from USFS road no. 3113-040 South to corner.

Signature  
*Walter R. Weir*

Title  
*PLS*

Division

Headquarters  
*PENDELTON*

Date  
*8/3/94*

6

7

8

2

3

4

5

CORNER RECORD (PERPETUATION)

MONUMENT: DESCRIBE NEW MONUMENT SET, OR WORK DONE TO PRESERVE EXISTING MONUMENT

A steel fence post set 3.8 feet West of monument with 54-2 and 54-9 signs attached.

ACCESSORIES : DESCRIBE NEW BT'S WITNESS OBJECTS ETC. ESTABLISHED, OR WORK DONE TO PRESERVE EXISTING EVIDENCE

A 20" ponderosa pine bears S 60 1/2°W-27.5 feet, scribed: T1S R36E S13 BT. New bearing tree has a brass washer stamped 'PLS 1106' nailed to the face of the blaze. Attached 54-3 and 54-9 signs, painted 6" red band and face of blaze red.

Work Done By. WR Wells Title PLS Date \_\_\_\_\_ State Registration No. or Agency PLS 1106

Certified Cor. Record Prepared ? Yes No Filed At: \_\_\_\_\_ Date \_\_\_\_\_

REMARKS

This corner was maintained as part of a USFS contract.

Index File No. T. R. M. Tract or Surv. No. Cor. J-25 1S 36E Willamette

Index File No. J-25  
 T 1 S 36 E  
 Merid. Willamette

**CORNER RECORD (SEARCH)**

(Ref. FSM 7151.4)

Tract or Survey No. J 25 Cor. No. Sec  
 R.D. Pendleton County Umatilla  
 N.F. Umatilla State Oregon

39

**CORNER DIAGRAM**

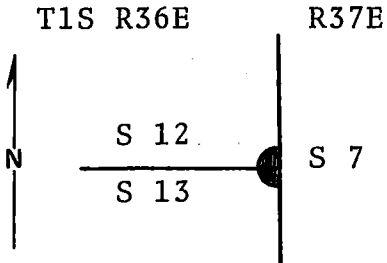

DESCRIBE CORNER MONUMENT FOUND Set brass cap summer 1972.  
Found a mound of stone with remains of original post in ground; from which

**DESCRIBE BEARING TREES OR OTHER OFFICIAL ACCESSORIES FOUND**

A pine 36" diam. live in good condition, with scribing visible, bears S27°W 37ft. distance.

**PHOTO IDENTIFICATION DATA**

Photo No. \_\_\_\_\_  
 Filed At. \_\_\_\_\_  
 Object Ident. \_\_\_\_\_  
 Ident. By \_\_\_\_\_

Apparently the original surveyor was in error as the record is 43.5 ft. distance.  
Accepted remains of old post as the corner position.

**DESCRIBE CORNER LOCATION RELATIVE TO NEAR-BY FEATURES, ALSO HOW TO REACH CORNER**

**PLANE COORDINATE POSITION DATA**

State \_\_\_\_\_ Zone \_\_\_\_\_  
 X \_\_\_\_\_  
 Y \_\_\_\_\_  
 Estab. By \_\_\_\_\_  
 Agency \_\_\_\_\_



Signature

Title

Division

Headquarters

Date

7100-52 (3/68)

CORNER RECORD (PERPETUATION)

MONUMENT: DESCRIBE NEW MONUMENT SET, OR WORK DONE TO PRESERVE EXISTING MONUMENT

Set 30x2½" iron pipe with 3" brass cap marked as shown, 25" in the ground and raised a mound of stone around the pipe for the corner to sections 12 & 13, from which new BTs:

ACCESSORIES : DESCRIBE NEW BT'S WITNESS OBJECTS ETC. ESTABLISHED, OR WORK DONE TO PRESERVE EXISTING EVIDENCE

A pine 14" diam. bears S78°E 48.3 ft. marked T1S R37E S7 BT.

A pine 12" diam. bears N34°W 79.5 Ft. marked T1S R36E S12 BT.

Distances taken to a brass washer in the blaze of each tree. Set a steel fence post approximately 5 ft. East from corner with "Attention" sign attached.

Used steel tape and magnetic compass with declination = 20° East.

Work Done By D.M. Ferguson Title Professional Land Surveyor Date 7/12/58 State Registration No. 848 Agency \_\_\_\_\_  
Certified Cor. Record Prepared?  Yes  No Filed At: Umatilla Co. Courthouse Date 11/16/72

REMARKS