

Index
File No. R-09

CORNER RECORD (SEARCH)
(Ref. FSM 7151.4)

Tract or
Survey No. _____
Cor.
No. _____

T 15 R. 36 E R.D. WALLA WALLA County UMATILLA

Merid. WILLAMETTE N.F. UMATILLA State OREGON

CORNER DIAGRAM

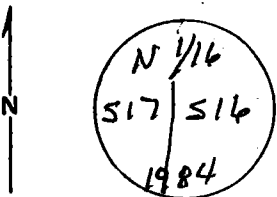

DESCRIBE CORNER MONUMENT FOUND

FND 3 1/2" BLM BRASS CAP RISING 4"
ABOVE GROUND

DESCRIBE BEARING TREES OR OTHER OFFICIAL ACCESSORIES FOUND

11" L PINE, BLAZED & SCRIBED N 1/16 517 BT,
BEARS N 33° W - 7 LKS - 4.6 FT.

10" L PINE, BLAZED & SCRIBED N 1/16 516 BT
BEARS S 35° E, 12 LKS - 7.9 FT.

PHOTO IDENTIFICATION DATA

Photo No. _____
Filed At. _____
Object Ident. _____
Ident. By _____
Signature

DESCRIBE CORNER LOCATION RELATIVE TO NEAR-BY FEATURES, ALSO HOW TO REACH CORNER

ON STEEP SOUTH SLOPE
130 FT EAST OF ROAD 3102-020

PLANE COORDINATE POSITION DATA

State _____ Zone _____
X _____
Y _____
Estab. By _____
Agency

Signature
D. Scott

Title
LS 1844

Division

Headquarters

Date

7-13-85

CORNER RECORD (PERPETUATION)

MONUMENT: DESCRIBE NEW MONUMENT SET, OR WORK DONE TO PRESERVE EXISTING MONUMENT

NONE

ACCESSORIES : DESCRIBE NEW BT'S WITNESS OBJECTS ETC. ESTABLISHED, OR WORK DONE TO PRESERVE EXISTING EVIDENCE

SET STEEL FENCE POST
ATTACHED SIGNS TO POST & BT'S
PAINTED 6" RED BANDS ON BT'S

Work Done By D.E. SCOTT Title SURVEYOR Date 7-13-85 State Registration No. LS 1844
Certified Cor. Record Prepared? Yes No Filed At: _____ Date _____

REMARKS:

Index File No. K-09 T. 15 R. 36E M. WM Tract or Surv. No. _____ Cor. N 4/16 S 17/516