

Form 874-9—Revised May, 1918

U. S. Department of Agriculture

FOREST SERVICE

Umatilla NATIONAL FOREST

CORNERS OF THE PUBLIC SURVEY

T. 15 R. 36E W. Mer.

Corner common to Sections

19, 20, 29, and 30

Corner consists of a Rock (not) in place  
State condition

Dimensions above ground 3 x 12 x 14 inches.

Sketch grooves, letters, figures, or notches, on proper face or edge.

CARDINAL POSITION

DIAGONAL POSITION



N W S E

NW SW SE NE

Mound of \_\_\_\_\_ is located \_\_\_\_\_

Pits are located \_\_\_\_\_

Sketch markings of Bearing Trees (or Rocks) in proper box and fill blanks below, giving bearings from Corner to Trees and Distances in Links.

--

T15 R36E S30
--------------------

--

T15 R36E S20
--------------------

--

BT
----

--

BT
----

Species YP YP

Diameter 25" 25"

Bearing S53W N4E

Distance 25' 65'

Do you believe this to be a genuine Land Office Corner? Yes

If not, why? \_\_\_\_\_

\_\_\_\_\_

Vance S. Resman  
(Signature)

11-14-33  
(Date)

Arthur Paul  
(Title)

T. 15 R. 36E 34W Mer.

(Make sketch of topography near Corner)

Sec. 29	Sec. 30
Sec. 31	Sec. 32

Metal Location Poster is on a VP tree 25 inches diameter, on the E side of Yucca from which this Corner bears N53E 25.1 chains distant.

Give any further facts which will aid in finding this Corner again.

Index File No. R-05

CORNER RECORD (SEARCH)

(Ref. FSM 7151.4)

Tract or Survey No. \_\_\_\_\_ Car. No. \_\_\_\_\_

T 15 R. 36 E R.D. WALLA WALLA County UMATILLA  
 Merid. WM N.F. UMATILLA State OREGON

CORNER DIAGRAM

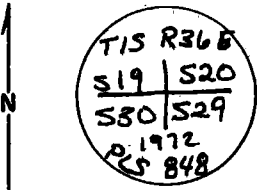

DESCRIBE CORNER MONUMENT FOUND

FND 3" BRASS CAP RISING 2" ABOVE GROUND

DESCRIBE BEARING TREES OR OTHER OFFICIAL ACCESSORIES FOUND

11" FIR, HEALED BLAZE, BEARS N 68° W, 41.4 FT  
 18" FIR, HEALED BLAZE, BEARS N 10° E, 23.3 FT.  
 26" PINE STUMP, B'S T15 R36 E S 20 BT, BEARS N 40° E,  
 76 LKS  
 16" FIR, HEALED BLAZE, BEARS S. 58° E, 56 FT.  
 22" P. PINE B'S R 36 E S30 BEARS S 55° W, 43 LKS.

PHOTO IDENTIFICATION DATA

Photo No. \_\_\_\_\_  
 Filed At. \_\_\_\_\_  
 Object Ident. \_\_\_\_\_  
 Ident. By \_\_\_\_\_  
 Signature \_\_\_\_\_

DESCRIBE CORNER LOCATION RELATIVE TO NEAR-BY FEATURES, ALSO HOW TO REACH CORNER

ON WEST SLOPE  
 ROAD 3102-020 TO BUTCHER CREEK E SECTION W  
 LINE THENCE SOUTH 1/4 MILE ALONG POSTED  
 LINE TO CORNER

PLANE COORDINATE POSITION DATA

State \_\_\_\_\_ Zone \_\_\_\_\_  
 X \_\_\_\_\_  
 Y \_\_\_\_\_  
 Estab. By \_\_\_\_\_  
 Agency \_\_\_\_\_

Signature D. Scott Title LS1844 Division \_\_\_\_\_ Headquarters \_\_\_\_\_ Date 6-26-85 FS-7100-52 (3/68)

CORNER RECORD (PERPETUATION)

MONUMENT: DESCRIBE NEW MONUMENT SET, OR WORK DONE TO PRESERVE EXISTING MONUMENT

NONE

ACCESSORIES : DESCRIBE NEW BT'S WITNESS OBJECTS ETC. ESTABLISHED, OR WORK DONE TO PRESERVE EXISTING EVIDENCE

SET STEEL FENCE POST

ATTACHED SIGNS TO POST & BT'S

Work Done By. D.E. SCOTT Title SURVEYOR Date 7-26-85 State Registration No. LS 1844

Certified Cor. Record Prepared? Yes No  Filed At:

Date

REMARKS

Index File No. R-05 T. 15 R. 36E W.M. WM. Tract or Surv. No. Cor. 19 | 20  
30 | 29

USDA-FOREST SERVICE

Index

File No. R-5

**CORNER RECORD (SEARCH)**

(Ref. FSM 7151.4)

Tract or Survey No. \_\_\_\_\_ Cor. No. \_\_\_\_\_

T 1S R. 36E

R.D. Pendleton County Umatilla

Merid. Willamette

N.F. Umatilla State Oregon

CORNER DIAGRAM

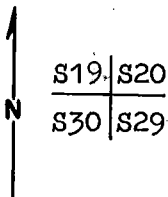

DESCRIBE CORNER MONUMENT FOUND

2 1/2" Gal. steel pipe with a 3" Brass cap properly stamped and firmly set in a small mound of stone.

DESCRIBE BEARING TREES OR OTHER OFFICIAL ACCESSORIES FOUND

Orig. 28" now 32" Pine stump N40E-76 lks. scribing intact.  
Orig. 20" now 26" Pine S55W-43 lks. majority of orig. scribing legible.

PHOTO IDENTIFICATION DATA

Photo No. 480-207  
Filed At. Umatilla N.F.  
Object Ident. Two I.P.'s  
Ident. By \_\_\_\_\_  
*Signature*

PLS 848 10" now 10" D-Fir-N68W, 41.4 ft. healed double blaze.  
PLS 848 20" now 17" D-Fir, N10E-23.3 ft. healed double blaze.  
PLS 848 16" now 16" D-Fir, S58E-56.2 ft. healed double blaze.

PLANE COORDINATE POSITION DATA

State \_\_\_\_\_ Zone \_\_\_\_\_  
X \_\_\_\_\_  
Y \_\_\_\_\_  
Estab. By \_\_\_\_\_  
*Agency*

DESCRIBE CORNER LOCATION RELATIVE TO NEAR-BY FEATURES, ALSO HOW TO REACH CORNER

From its junction with Rd.#3102 follow spur 020 one mile to posted N/S line. Corner is approx. 400 ft. North and one-quarter mile West across ridge.

Signature

*Larry O. Brasing*

Title Land Surveyor Division \_\_\_\_\_

Headquarters \_\_\_\_\_

Date 10/82 7100-52-(3.68)

CORNER RECORD (PERPETUATION)

MONUMENT: DESCRIBE NEW MONUMENT SET, OR WORK DONE TO PRESERVE EXISTING MONUMENT

ACCESSORIES : DESCRIBE NEW BT'S WITNESS OBJECTS ETC. ESTABLISHED, OR WORK DONE TO PRESERVE EXISTING EVIDENCE

Work Done By Larry D. Bishop Title Surveyor Date 10/82 State Registration No. 896  
or Agency \_\_\_\_\_  
Certified Cor. Record Prepared? Yes  No  Filed At: \_\_\_\_\_ Date \_\_\_\_\_

REMARKS

Nailed 54-4 and BT signs to BT's as needed and painted band and blazes red.  
Set guard post East with sign 54-4.

Index File No. T. R. M. Tract or Surv. No. Cor.

Index File No. R-5

**CORNER RECORD (SEARCH)**

(Ref. FSM 7151.4)

Tract or Survey No. R 5

Cor. No.      Sec. 22

T 1 S R R 36 E

R.D. Pendleton County Umatilla

Merid. Willamette

N.F. Umatilla State Oregon

60

**CORNER DIAGRAM**

T1S R36E

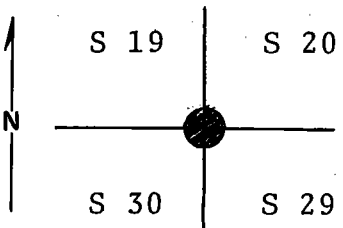

**DESCRIBE CORNER MONUMENT FOUND**

Set brass cap summer 1972. See reverse side.

**DESCRIBE BEARING TREES OR OTHER OFFICIAL ACCESSORIES FOUND**

Found a 30" pine stump, with all scribing visible, bearing N40°E 49 ft. dist. from the corner position. Found a 26" pine, live in good condition with scribing visible, bearing S55°W 27 ft. dist. from corner position.

Found the remains of a pine stump, rotted off flush with the ground, bearing N75°W 17.2 ft. dist from

**DESCRIBE CORNER LOCATION RELATIVE TO NEAR-BY FEATURES, ALSO HOW TO REACH CORNER**

the corner position.

**PHOTO IDENTIFICATION DATA**

Photo No. \_\_\_\_\_  
 Filed At. \_\_\_\_\_  
 Object Ident. \_\_\_\_\_  
 Ident. By \_\_\_\_\_  
*Signature*

**PLANE COORDINATE POSITION DATA**

State \_\_\_\_\_ Zone \_\_\_\_\_  
 X \_\_\_\_\_  
 Y \_\_\_\_\_  
 Estab. By \_\_\_\_\_  
*Agency*



Signature \_\_\_\_\_ Title \_\_\_\_\_ Division \_\_\_\_\_ Headquarters \_\_\_\_\_ Date \_\_\_\_\_

