

T-5

History of original corner establishment:

This corner was originally established by Deputy Herman D. Gradon in Oct. 1882 under contract No. 452.

Set a Basalt stone 22"x10"x5" marked ¼ on West face.
 Scribed 3" Fir S85E-83 or 33 lks..
 24" Pine N55W-9 lks..

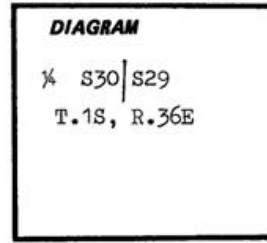

T-5

Description of corner evidence found:

Stone 19"x10"x5" with ¼ chisled vertically on face on ground.
 Orig. 24" Pine now charred remains of large Pine stump N55W-9 lks..

Description of monument and accessories I established to perpetuate the original location of this corner:

Set 2½"x30" Gal. steel pipe 26" in ground.

New Bearing Trees:

8" Larch S70½W, 27.4 ft. scribed ¼S30BT and with a 1" Brass disk stamped PLS 896.
 8" D-Fir N74E, 21.2 ft. scribed ¼S29BT and with a 1" Brass disk stamped PLS 896.

Marked

T.1S R.36E

¼

S30 | S29

1982

PLS 896

Set guard post North with sign 54-4 only.
 Nailed 54-4 and BT signs to BT's and painted band and blazes red.

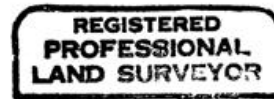

Larry D. Bishop

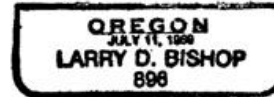

Office of County Surveyor County of Umatilla
 State of Oregon, I hereby certify that the within instrument was filed in this office
 for record on the 17 day of November, 1982
David H. Drumheller by Betty Shadd
 (COUNTY OFFICIAL) (DEPUTY)

Form R6-7100-57 (9/71)

RECEIVED BY
 Umatilla County Surveyor 700-276
 Date 11-17-82
 Rec'd By Bd S.
 No. 82-114-B