

CERTIFIED RECORD OF LAND CORNER MONUMENTATION

History of original corner establishment:

Corner originally established by Henry Meldrum under GLO contract number 450, dated June 11, 1882. Surveyor General record states:

Set basalt stone 18x10x6 ins 12 in in ground for cor to secs 3, 4, 9 + 10 marked with 5 notches on S + 3 on E edges, and raised mound of stone alongside. Pits impracticable in open glade on hillside 500 ft. above creek from which;

A pine 50 in diam bears S32°W 87 lks dist marked T1S R37E S9 BT

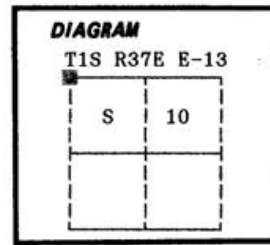

No record of subsequent monumentation found in Umatilla County survey records.

Description of corner evidence found:

Found a stone 14x10x7 inches marked with 5 grooves on one face and 3 grooves on another.

ORIGINAL BEARING TREE

Found a 50 inch diameter Ponderosa Pine root hole S32°W, 87 links with tree dead, down and very rotted approximately 20 feet Southwest of the root hole with no marks visible.

Description of monument and accessories I established to perpetuate the

original location of this corner: In place of the found original corner stone, I set a 2½" x 30" aluminum pipe with aluminum cap marked as shown, 21 inches in the ground, from which:

New Bearing Trees:

- A 12 inch diameter Ponderosa Pine bears N13°E, 122.20 feet marked T1S R37E S3 BT
- A 14 inch diameter Douglas Fir bears S48°E, 190.60 feet marked T1S R37E S10 BT
- A 11 inch diameter Ponderosa Pine bears S24°W, 49.20 feet marked T1S R37E S9 BT
- A 11 inch diameter Douglas Fir bears N80°W, 62.47 feet marked T1S R37E S4 BT

Set a steel fencepost approximately 5 feet North with land survey monument sign attached.

Raised a mound of stone around monument, 3 ft. base to top of cap.

Painted a 6 inch red band around all BTs and attached Bearing tree and land survey monument signs.

Buried the original corner stone South and alongside of monument.

I hereby certify that the above corner point was perpetuated as hereon described on August 20, 1989.

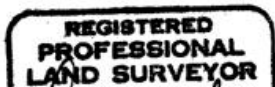

David H. Kaumdeen
OREGON
JULY 10, 1984
DUANE I. GRIFFITH
644

I used a steel tape and magnetic compass in the establishment of new accessories. I used 17° East magnetic declination and the distances are to a 50d spike driven in the right side of the root crown. I attached a brass washer marked OPLS 644 to the BT blaze.

Office of the Survey Dept County of Umatilla
State of OR I hereby certify that the within instrument was filed in this office
for record on the 27th day of October, 1989
David H. Kaumdeen by Kathleen K. Amosberg
(COUNTY OFFICIAL) (DEPUTY)

Form R6-7100-57 (9/71)

RECEIVED BY

*GPO-591-971, 1988

Umatilla County Survey Dept
Date 10-89
Sheet KA
No. 89-106-R