

USDA-FOREST SERVICE

Index File No. J-13

CORNER RECORD (SEARCH)

(Ref. FSM 7151.4)

Tract or Survey No. \_\_\_\_\_ No. \_\_\_\_\_

T K IS R. 37E

R.D. \_\_\_\_\_ County UMATILLA-UNION

Merid. WILLAMETTE

N.F. \_\_\_\_\_ State OREGON

CORNER DIAGRAM

T1S R37E

9 | 10

16 | 15

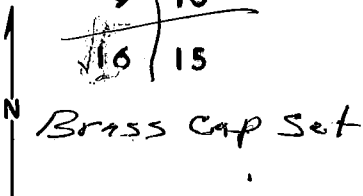

DESCRIBE CORNER MONUMENT FOUND

FOUND 30"x18"x3" STONE IN MOUND OF STONES

DESCRIBE BEARING TREES OR OTHER OFFICIAL ACCESSORIES FOUND

24" Fir snag S82E 147.2' (Scribes visible)

PHOTO IDENTIFICATION DATA

Photo No. \_\_\_\_\_

Filed At. \_\_\_\_\_

Object Ident. \_\_\_\_\_

Ident. By \_\_\_\_\_

Signature

PLANE COORDINATE POSITION DATA

State \_\_\_\_\_ Zone \_\_\_\_\_

X \_\_\_\_\_

Y \_\_\_\_\_

Estab. By \_\_\_\_\_

Agency

DESCRIBE CORNER LOCATION RELATIVE TO NEAR-BY FEATURES, ALSO HOW TO REACH CORNER

GO UP MT. EMILY ROAD (N31) ABOUT 9.6 MILES TO A LARGE MEADOW ON LEFT SIDE OF ROAD. THERE IS A LOCATION TAG FURTHER DOWN THE ROAD. CORNER IS 300 FEET INTO LARGE MEADOW.

Signature

*W O Harris*

Title

Division

Headquarters

Date

*7-31-78*

7100-52-(3/68)

## CORNER RECORD (PERPETUATION)

GPO 902-673

MONUMENT: DESCRIBE NEW MONUMENT SET, OR WORK DONE TO PRESERVE EXISTING MONUMENT

SET A 2" X 30" IRON PIPE WITH BRASS CAP.  
 PIPE IS SET IN MOUND OF STONES WITH ORIGINAL STONE NEAR BOTTOM.

TIS R37E

S9 | S10

S16 | S18

1078

RLS 346

ACCESSORIES: DESCRIBE NEW BT'S WITNESS OBJECTS ETC. ESTABLISHED, OR WORK DONE TO PRESERVE EXISTING EVIDENCE

6" STEEL FENCE POSTS ON SOUTH AND EAST SIDES OF CORNER

40" D. FIR S30E 265.2 Mkd. TIS R37E S15 BT

14" D. FIR N32E 192.8 Mkd. TIS R37E S10 BT

10" LARGH N18 W 144.5 Mkd. TIS R37E S16 BT

6" Fir S35W 151.4° Mkd. TIS R37E S16 BT

ALL BT'S HAVE 54-384 SIGNS AND RED PAINTED STRIPE  
 New BT's have a brass washer stamped RLS 346 nailed to lower face

Work Done By WAYNE HARRISDate 7.31.78 State Registration No. RLS 346  
or Agency

Certified Cor. Record Prepared? Yes

No

Filed At:

Date

REMARKS

Index File No.

T.

R.

M.

Tract or Surv. No.

Cor.

12

13

Index  
File No. J-13  
T 15 R. 37E  
Merid. Willamette

**CORNER RECORD (SEARCH)**

(Ref. FSM 7151.4)

R.D. Pendleton County \_\_\_\_\_  
N.F. Umatilla State Oregon  
Tract or Survey No. \_\_\_\_\_ Cor. No. J-13

**CORNER DIAGRAM**

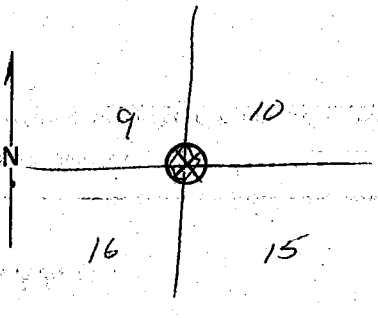

**DESCRIBE CORNER MONUMENT FOUND**

Pile of stones in opening.

**DESCRIBE BEARING TREES OR OTHER OFFICIAL ACCESSORIES FOUND**

One 22" Douglas Fir tree.  
In S.E. Quadrant.  
Large Blaze on West Face.

**PHOTO IDENTIFICATION DATA**

Photo No. \_\_\_\_\_  
Filed At: \_\_\_\_\_  
Object Ident. \_\_\_\_\_  
Ident. By: \_\_\_\_\_  
Signature \_\_\_\_\_

Possible B.T. was painted in S.W. quadrant. Is a blow-down, possibly laying on blaze.

**DESCRIBE CORNER LOCATION RELATIVE TO NEAR-BY FEATURES, ALSO HOW TO REACH CORNER**

located about 10 chains off of N-31 where N-31 is intersected by section line between section 15 & 16.

**PLANE COORDINATE POSITION DATA**

State \_\_\_\_\_ Zone \_\_\_\_\_  
X \_\_\_\_\_  
Y \_\_\_\_\_  
Estab. By \_\_\_\_\_  
Agency \_\_\_\_\_

Title Forester Division T/M Headquarters Pendleton Date 6-28-73  
7100-52 (3/68)

Signature Ryland S. Sandman

CORNER RECORD (PERPETUATION)

MONUMENT: DESCRIBE NEW MONUMENT SET, OR WORK DONE TO PRESERVE EXISTING MONUMENT

Pile of stones was painted fluorescent orange to increase visibility. Also, a painted stake was set up next to corner.

ACCESSORIES: DESCRIBE NEW BT'S WITNESS OBJECTS ETC. ESTABLISHED, OR WORK DONE TO PRESERVE EXISTING EVIDENCE

The BT & the possible BT were painted with Fluor orange paint and flagged with red plastic ribbon.

Work Done By: Hardman Title: Forester Date: 6-28-73 State Registration No. or Agency

Certified Cor. Record Prepared? Yes  No  Filed At: \_\_\_\_\_ Date \_\_\_\_\_

REMARKS

LAND CORNER RECORD

1. T 15 R 37E No. J13 Cor. Sec. Mer. W State Ore (Rectangular) N. F. Umatilla Dist. Pend. 4

2. Corner Status

3. Original Description \_\_\_\_\_ Vol. 279 Page 350 Where Recorded BLM Portland

4. Description of Corners: Basalt stone 30"x18"x3" - 23" in ground marked with 4 notches on S & 3 on E edges from which a fir 24" dia bears N15°E 144 lks marked T1S, S10B.T., a fir 18" dia bears N30°W222 lks marked R37E S9BT, a fir 12" in dia bears S18°W252 lks marked S16BT, a fir 10" dia bears S82°E 223 lks marked S15 BT.

5. Investigation Notes:

by compass & pacing we found a rock 3"x18"x24" - 24" above ground (propped up by rocks) marked with 3 notches on E & 4 notches on S faces from which a 22" fir bears S80°E 150' approx. & is marked S15BT

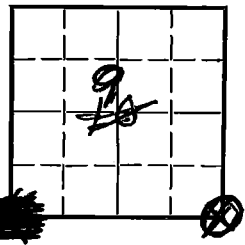

7. Photo Identification

Photo No. \_\_\_\_\_  
Ident. By: \_\_\_\_\_

8. Plane Coordinate Position Data

State \_\_\_\_\_ Zone \_\_\_\_\_  
X \_\_\_\_\_  
Y \_\_\_\_\_  
Estab. By \_\_\_\_\_  
Field Book No. \_\_\_\_\_  
Where Filed \_\_\_\_\_

9. Evaluation

Authentic \_\_\_\_\_  
Needs Verif. \_\_\_\_\_ Monument no  
Re-estab. X Survey \_\_\_\_\_  
Land Status U.S.

6. Signed R. C. Holmes Title Engineering Asst Date 7-26-62

PERPETUATION RECORD

10. Monument:

11. Accessories

Field Book \_\_\_\_\_ Page \_\_\_\_\_

12. Set By \_\_\_\_\_ Title \_\_\_\_\_

13. Recorded By \_\_\_\_\_ Volume \_\_\_\_\_ Page \_\_\_\_\_

(Agency)

License \_\_\_\_\_ Agency \_\_\_\_\_ Date \_\_\_\_\_

(Date) \_\_\_\_\_ (City) \_\_\_\_\_ (County) \_\_\_\_\_ (State) \_\_\_\_\_

14. Remarks:

J-13