

CERTIFIED RECORD OF LAND CORNER MONUMENTATION

History of original corner establishment:

Corner originally established by Henry Meldrum under GLO contract number 450, dated June 11, 1882. Surveyor General record states:

Set basalt stone 24x12x7 ins 18 in in ground for cor to secs 15, 16, 21 + 22 marked with 3 notches on S + E edges, from which;

- A fir 14 in diam bears N4°W 7 lks dist marked R37E S16 BT
- A tamarack 15 in diam bears N82°E 14 lks dist marked T1S S15 BT
- A fir 18 in diam bears S42°E 14 lks dist marked S22 BT
- A tamarack 12 in diam bears S42°W 14 lks dist marked S21 BT

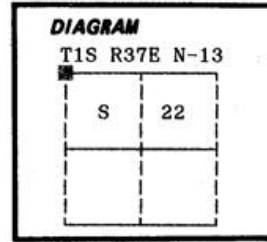

No record of subsequent monumentation found in Umatilla County survey records.

Description of corner evidence found:

Found a stone 24x15x7 inches marked with 3 grooves on the South and East faces, in a small mound of stone.

ORIGINAL BEARING TREES

Found a 18 inch diameter Western Larch N82°E, 14 lks, dead and down with scribes visible.

Found a root hole S42°E, 14 lks.

Found the rotted remains of a Fir stump N4°W, 7 lks, with no marks visible.

Found no evidence of the original Southwest bearing tree.

Distances to the original BTs are to the estimated face of blaze.

Description of monument and accessories established to perpetuate the

original location of this corner: In place of the found original corner stone, I set a 2½" x 30" aluminum pipe with aluminum cap marked as shown, 26 inches in the ground, from which:

New Bearing Trees:

- A 14 inch diameter Douglas Fir bears N77°E, 23.34 feet marked T1S R37E S15 BT
- A 12 inch diameter Western Larch bears S47°E, 42.22 feet marked T1S R37E S22 BT
- A 12 inch diameter Douglas Fir bears S63°W, 38.89 feet marked T1S R37E S21 BT
- A 13 inch diameter White Fir bears N37°W, 21.30 feet marked T1S R37E S16 BT

- Painted a 6 inch red band around all BTs and attached bearing tree and land survey monument signs.
- Set a steel fencepost approximately 5 feet North with land survey monument sign attached.
- Raised a mound of stone around monument, 2 ft. base to top of cap.
- Buried the original corner stone West and alongside of monument.

I hereby certify that the above corner point was perpetuated as hereon described on August 2, 1989.

Witness: Rick Robinson

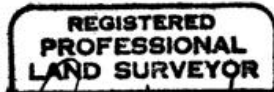

[Handwritten signature]

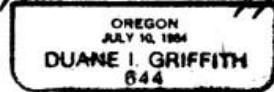

I used a steel tape and magnetic compass in the establishment of new accessories. I used 17° East magnetic declination and the distances are to a 50d spike driven in the right side of the root crown. I attached a brass washer marked OPLS 644 to the BT blaze.

Office of The Survey Dept. County of Umatilla
 State of OR I hereby certify that the within instrument was filed in this office
 for record on the 27th day of October 1989
David H. Humbein by Kathleen S. Amberg
 (COUNTY OFFICIAL) (DEPUTY)

Form R6-7100-57 (9/71)

*GPO-591-971, 1988

RECORDED BY
 INDEXED BY
 FILED BY
 No. 89-106-R