

USDA-FOREST SERVICE

Index

File No. R-01

**CORNER RECORD (SEARCH)**

(Ref. FSM 7151.4)

Tract or

Survey No. \_\_\_\_\_

Cor.

No. \_\_\_\_\_

T 1S R.37E

R.D. WALLA WALLA

County UMATILLA

Merid. WILLAMETTE

N.F. UMATILLA

State OREGON

**CORNER DIAGRAM**

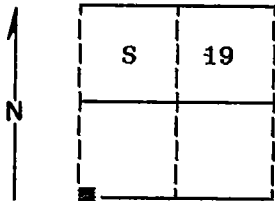

**DESCRIBE CORNER MONUMENT FOUND**

Found a stone 14x9x6 inches marked with 4 grooves on one face, 2 grooves on one face and 6 grooves on one face. Stone is in a recently made mound of stone approximately 4 feet Southeast of the true corner position as located by pulling the record distance from the found original bearing trees.

**DESCRIBE BEARING TREES OR OTHER OFFICIAL ACCESSORIES FOUND**

Found a 27 inch diameter Ponderosa Pine N39°E, 20 lks live and vigorous with scribes visible. (Record N47°E)  
Found a 28 inch diameter Ponderosa Pine S55°E, 85 lks live and vigorous with scribes visible. (Record S50°E)  
Found a rotted Ponderosa Pine snag S74°W, 47 lks with scribes visible.

**DESCRIBE CORNER LOCATION RELATIVE TO NEAR-BY FEATURES, ALSO HOW TO REACH CORNER**

Corner falls in timbered Southwest slope approximately 600 feet East of the 3109 road, 10 feet West of the 025 road blocked approximately 1/4 mile South at the junction with the 3109 road.

**PHOTO IDENTIFICATION DATA**

Photo No. \_\_\_\_\_

Filed At. \_\_\_\_\_

Object Ident. \_\_\_\_\_

Ident. By \_\_\_\_\_

*Signature*

**PLANE COORDINATE POSITION DATA**

State \_\_\_\_\_ Zone \_\_\_\_\_

X \_\_\_\_\_

Y \_\_\_\_\_

Estab. By \_\_\_\_\_

*Agency*

*Signature*

Title

Surveyor

Division

Headquarters

Date

8-24-89

FS-7100-52 (3/68)

5

## CORNER RECORD (PERPETUATION)

**MONUMENT: DESCRIBE NEW MONUMENT SET, OR WORK DONE TO PRESERVE EXISTING MONUMENT**

Set a 2½"x30" aluminum pipe with aluminum cap marked as shown:  
Pipe is set 8 inches in the ground.

T1S  
R36E R37E  
C C  
| S 19  
S 25 | S 30  
1989  
OPLS 644

Raised a mound of stone around monument, 5 ft. base to top of cap.  
Buried the original corner stone West and alongside of monument.

**ACCESSORIES : DESCRIBE NEW BT's WITNESS OBJECTS ETC. ESTABLISHED, OR WORK DONE TO PRESERVE EXISTING EVIDENCE**

Painted a 6 inch red band around all bearing trees and attached 54-3 and 54-9 signs.  
Set a steel fence post approximately 5 feet North with 54-9 sign attached.

Work Done By D.I. Griffith Title Surveyor Date 8-4-89 State Registration No. OPLS 644  
or Agency

Certified Cor. Record Prepared ? Yes  No  Filed At: Umatilla Co. Surveyor's Office Date 9-89

### REMARKS

Witnesses: Jeff Petersen and Rick Robinson

Index File No. R-01 T. 1S R. 37E W.M. Tract or Surv. No. Cor.

USDA-FOREST SERVICE

Index  
File No. R-1

CORNER RECORD (SEARCH)

(Ref. FSM 7151.4)

Tract or Survey No. \_\_\_\_\_ Cor. No. \_\_\_\_\_

T 15 R. 37E

R.D. Pendleton County Umatilla

Merid. W

N.F. Umatilla State Ore.

CORNER DIAGRAM

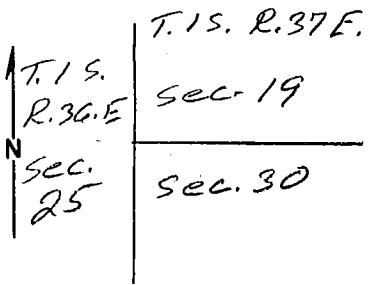

DESCRIBE CORNER MONUMENT FOUND

Stone 6 1/2" x 13" x 5" - 5" above ground with 6 notches on top and 2 notches on East.

DESCRIBE BEARING TREES OR OTHER OFFICIAL ACCESSORIES FOUND

21" P.P. Az. 19° 19 1/2 Links  
27" P.P. Az 1300 80 Links.

PHOTO IDENTIFICATION DATA

Photo No. \_\_\_\_\_  
Filed At. \_\_\_\_\_  
Object Ident. \_\_\_\_\_  
Ident. By \_\_\_\_\_  
Signature \_\_\_\_\_

DESCRIBE CORNER LOCATION RELATIVE TO NEAR-BY FEATURES, ALSO HOW TO REACH CORNER

PLANE COORDINATE POSITION DATA

State \_\_\_\_\_ Zone \_\_\_\_\_  
X \_\_\_\_\_  
Y \_\_\_\_\_  
Estab. By \_\_\_\_\_  
Agency \_\_\_\_\_

Signature

*H. E. Call*

Title

*Recorder*

Division

*T. 1*

Headquarters

*Pendleton*

Date

*10.10.78*

7100-52-(3/68)

LAND CORNER RECORD

1. T. 1S R. 37E No. R 1 Cor. Sec. Mer. Will. State Oregon (Rectangular) N. F. Umatilla Dist. Pendleton 7

2. Corner Status

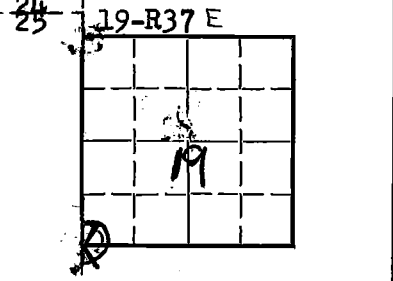

7. Photo Identification  
Photo No. DVD 2M-20  
Ident. By: \_\_\_\_\_

8. Plane Coordinate Position Data  
State \_\_\_\_\_ Zone \_\_\_\_\_  
X \_\_\_\_\_  
Y \_\_\_\_\_  
Estab. By \_\_\_\_\_  
Field Book No. \_\_\_\_\_  
Where Filed \_\_\_\_\_

9. Evaluation  
Authentic \_\_\_\_\_  
Needs Verif. Monument NO  
Re-estab. Survey  
Land Status \_\_\_\_\_

3. Original Description Re-survey 61.279 Page 203 & 284 Where Recorded \_\_\_\_\_

4. Description of Corners:  
Set Basalt Stone 16x10x7" in ground for <sup>Corner</sup> ~~corner~~ to Sec. 19 & 30 marked with 2 notches on S and 4 on N edges, from which a Pine 5" diam. bears N 47° E 20 lks. dist. marked T1S, S19BT. A pine 18" diam. bears S 74° W 47 lks dist. marked R36E BT. A pine 24" diam. bears S 50° E 85 lks. dist. marked R37E S 30 BT. Land

5. Investigation Notes: mountainous. Timber Pine, Fir, and Tamarack.  
Basalt Stone 14"x9"x6" in good condition.  
Markings: 2S 4N, 6 notches on top.  
Bearing Trees:  
18" Pine bears N 47° E, 20 links from stone. No markings in blazes.  
27" Pine bears S 50° E, 85 links from stone. T1S, S 30. markings visable.  
21" burned stump S 74° W 47 links from stone. Side of stump burned away.

The blazes appear to have been chopped in badly at least 50 years ago. Corner was found approximately 10 chains South of corner of T1S, R36E, Sec. 24 and 25.

See T1S, R36E, Sec. 24

6. Signed N. Carr Title Surveying Aid Date 10-22-64

PERPETUATION RECORD

10. Monument:

11. Accessories

Field Book \_\_\_\_\_ Page \_\_\_\_\_

12. Set By \_\_\_\_\_ Title \_\_\_\_\_

License \_\_\_\_\_ Agency \_\_\_\_\_ Date \_\_\_\_\_

13. Recorded By \_\_\_\_\_ Volume \_\_\_\_\_ Page \_\_\_\_\_  
(Agency)

(Date) (City) (County) (State)

14. Remarks:

R-1