

USDA-FOREST SERVICE

Index File No. V-9

CORNER RECORD (SEARCH)

(Ref. FSM 7151.4)

Tract or Survey No. \_\_\_\_\_ Cor. No. \_\_\_\_\_

T 1S R. 37E

R.D. WALLA WALLA County UMATILLA-UNION LINE

Merid. Will

N.F. UMATILLA State OREGON

CORNER DIAGRAM

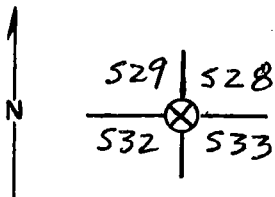

DESCRIBE CORNER MONUMENT FOUND

STONE, 20x16x12 inches LYING LOOSE ON GROUND. NO MARKS VISIBLE.

DESCRIBE BEARING TREES OR OTHER OFFICIAL ACCESSORIES FOUND

A SAWN & DECAYED FIR STUMP, NO MARKS VISIBLE, BEARS N62°E, 66 FT. A LARGE PINE STUMP IS BURNT & TIPPED OUT OF THE GROUND. STUMP HOLE BEARS N60°W, 48.8 FT. THE BURNT REMAINS OF A LARGE PINE STUMP BEARS S17°W, 116.8 FT. ORIGINAL BT TO SE IS GONE.

PHOTO IDENTIFICATION DATA

Photo No. \_\_\_\_\_  
 Filed At. \_\_\_\_\_  
 Object Ident. \_\_\_\_\_  
 Ident. By \_\_\_\_\_  
 Signature \_\_\_\_\_

DESCRIBE CORNER LOCATION RELATIVE TO NEAR-BY FEATURES, ALSO HOW TO REACH CORNER

LOCATED ON A FLAT RIDGE TOP AT THE N.E. EDGE OF A SMALL OPENING. THERE IS A M.O.I.S. 40 FT WEST, BUT I DO NOT BELIEVE IS THE CORNER. OLD BDRY SIGNS SOUTH & WEST. THIS POSITION IS HARMONIOUS WITH CORNERS 1/2 MILE SOUTH & WEST. I DID NOT SIGN THIS CORNER.

PLANE COORDINATE POSITION DATA

State \_\_\_\_\_ Zone \_\_\_\_\_  
 X \_\_\_\_\_  
 Y \_\_\_\_\_  
 Estab. By \_\_\_\_\_  
 Agency \_\_\_\_\_

Signature

Title

Division

Headquarters

Date

FS-7100-52 (3/68)

Dennis L. Maynard

L.S. 1636

S.O.

6-7-88

**CORNER RECORD (PERPETUATION)**

**MONUMENT : DESCRIBE NEW MONUMENT SET, OR WORK DONE TO PRESERVE EXISTING MONUMENT**

9

**ACCESSORIES : DESCRIBE NEW BT'S WITNESS OBJECTS ETC. ESTABLISHED, OR WORK DONE TO PRESERVE EXISTING EVIDENCE**

10

Work Done By \_\_\_\_\_ Title \_\_\_\_\_ Date \_\_\_\_\_ State Registration No.  
or Agency \_\_\_\_\_

Certified Cor. Record Prepared ? Yes No Filed At: \_\_\_\_\_ Date \_\_\_\_\_

11

**REMARKS**

12

Index File No. T. R. M. Tract or Surv. No. Cor. 13

USDA-FOREST SERVICE

Index File No. V-9

**CORNER RECORD (SEARCH)**

(Ref. FSM 7151.4)

Tract or Survey No. \_\_\_\_\_ No. V-9

T 1S R. 37E

R.D. Pendleton County Umatilla

Merid. Willamette

N.F. Umatilla State Oregon

CORNER DIAGRAM

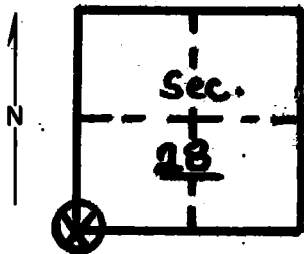

DESCRIBE CORNER MONUMENT FOUND

Material: Basalt stone  
 Height Above Ground: 8"  
 Markings: None visible.  
 Size: 20x10x10  
 Condition: Poor

DESCRIBE BEARING TREES OR OTHER OFFICIAL ACCESSORIES FOUND

30" fir stump 18" high - N62E - approx. 75' dist.  
 Stump holes in the other 3 quadrants fitting G.L.O. notes for B.T.'s. Stump is @ intersection of south and west blaze lines which are marked with old metal FS boundary markers. There is also evidence of old fences east, west and south.

PHOTO IDENTIFICATION DATA

Photo No. \_\_\_\_\_  
 Filed At. \_\_\_\_\_  
 Object Ident. \_\_\_\_\_  
 Ident. By \_\_\_\_\_  
*Signature.* \_\_\_\_\_

DESCRIBE CORNER LOCATION RELATIVE TO NEAR-BY FEATURES, ALSO HOW TO REACH CORNER

PLANE COORDINATE POSITION DATA

State \_\_\_\_\_ Zone \_\_\_\_\_  
 X \_\_\_\_\_  
 Y \_\_\_\_\_  
 Estab. By \_\_\_\_\_  
*Agency* \_\_\_\_\_

Signature  
 Bill Moore

Title  
 Eng. Tech.

Division \_\_\_\_\_ Headquarters \_\_\_\_\_

Date  
 6/77

7100-52-(3/68)

CORNER RECORD (PERPETUATION)

MONUMENT: DESCRIBE NEW MONUMENT SET, OR WORK DONE TO PRESERVE EXISTING MONUMENT

9

ACCESSORIES: DESCRIBE NEW BT'S WITNESS OBJECTS ETC. ESTABLISHED, OR WORK DONE TO PRESERVE EXISTING EVIDENCE

I tied yellow ribbon on ~~the old oak tree.~~  
blazed line south and west.

10

Work Done By \_\_\_\_\_ Title \_\_\_\_\_ Date \_\_\_\_\_ State Registration No. or Agency \_\_\_\_\_

Certified Cor. Record Prepared? Yes No Filed At \_\_\_\_\_ Date \_\_\_\_\_

REMARKS

12

Index File No. T. R. M. Tract or Surv. No. Cor. 13