

Form 874-9—Revised May, 1918
U. S. Department of Agriculture
FOREST SERVICE

Copy

Amatulla NATIONAL FOREST

CORNERS OF THE PUBLIC SURVEY

T. 14 25 R. 37 E W Mer.

Section Corner common to Sections
31, and 6

Corner consists of a stake (~~not~~) in place
State condition Very poor

Dimensions above ground 2" X 1 1/2" X 3" inches.

Sketch grooves, letters, figures, or notches, on proper face or edge.
CARDINAL POSITION DIAGONAL POSITION

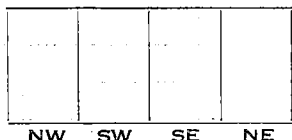
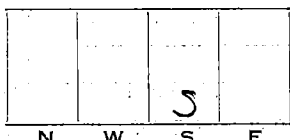

Mound of _____ is located _____

Pits are located _____

Sketch markings of Bearing Trees (or Rocks) in proper box and fill blanks below, giving bearings from Corner to Trees and Distances in Links.

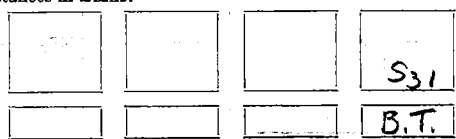

Species _____ Y.P.
Diameter _____ 16"
Bearing _____ N 70 E
Distance _____ 1/4 chm.

Do you believe this to be a genuine Land Office Corner? Yes

If not, why? _____

/s/ Gerald J. Tucker
(Signature)

Aug. 9, 1932
(Date)

Forest Ranger
(Title)

T. 142 S R. 37E W Mer.

(Make sketch of topography near Corner)

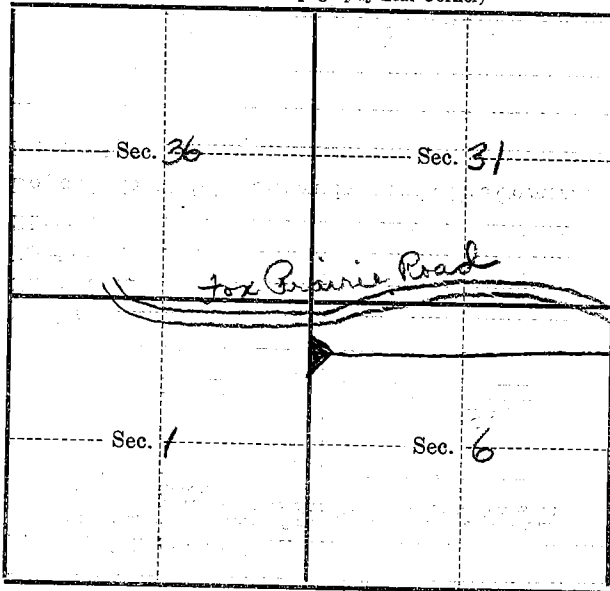

Metal Location Poster is on a V.P.
tree 14 inches diameter, on the South
side of Corner
from which this Corner bears N-20W
1/2 chains distant.

Give any further facts which will aid in finding this
Corner again.

Approx. 20 rods south of
section line board which lies
on South side of Fox Prairie
Road 5 ft from road.

USDA-FOREST SERVICE

index
File No. Z-1

CORNER RECORD (SEARCH)
(Ref. FSM 7151.4)

Tract or
Survey No. _____
Cor.
No. _____

T 15 R. 37E

R.D. WALLA WALLA County UNION - UMATILLA LINE

Merid. WILLI

N.F. UMATILLA State OREGON

CORNER DIAGRAM

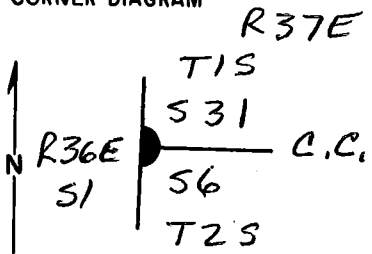

DESCRIBE CORNER MONUMENT FOUND

ORIGINAL CORNER TREE IS DOWN & DECAYED.
SCRIBES VISIBLE, "00"
|||
|||

DESCRIBE BEARING TREES OR OTHER OFFICIAL ACCESSORIES FOUND

STUMP HOLES IS ALL THAT REMAINS OF
THE TWO ORIGINAL BT'S:
N64°E, 26.4 ft.
S35°E, 5.5 ft.

PHOTO IDENTIFICATION DATA

Photo No. _____
Filed At. _____
Object Ident. _____
Ident. By _____
Signature _____

DESCRIBE CORNER LOCATION RELATIVE TO NEAR-BY FEATURES, ALSO HOW TO REACH CORNER

200' South of Road 31

PLANE COORDINATE POSITION DATA

State _____ Zone _____
X _____
Y _____
Estab. By _____
Agency _____

Signature Dennis L. Layland Title S.O. Division _____ Headquarters PLS 1636 Date May 8, 1986 FS-7100-52 (3/68)

CORNER RECORD (PERPETUATION)

MONUMENT: DESCRIBE NEW MONUMENT SET, OR WORK DONE TO PRESERVE EXISTING MONUMENT

in the center of the corner tree stump hole & set a 2 1/2" Alum pipe x 30" long w/ 2 1/2" Alum Cap, Cap is protruding 5" & is marked

T 15
 R 51 | 531 C R
 E 56 C 7
 1986 PLS 1636 E

ACCESSORIES : DESCRIBE NEW BT'S WITNESS OBJECTS ETC. ESTABLISHED, OR WORK DONE TO PRESERVE EXISTING EVIDENCE

21" Ponderosa Pine N58°E 43.8ft, Scribed "T15 R37E 531 CC BT"
 14" W. LARCH S1°W, 39.5ft, scribed "T25 R37E 56 CC BT"
 Both BT'S have a 3/4" brass washer marked "PLS 1636"
 nailed to the blaze between the B & T. Both BT'S have
 54-3 & 54-4 sign signs nailed to them.

Work Done By D. GAYLORD Title FOREST L.S. Dgte 5-8-86 State Registration No. OR 1636
 or Agency

Certified Cor. Record Prepared? Yes No Filed At: UNION & UMATILLA Co. SUR. Date May 1986

REMARKS

Index File No. Z-1 T. 15 R. 37E M. WILL Tract or Surv. No. Cor. 13
 GPO : 1984 O - 439-095

LAND CORNER RECORD

44 5680-2

1. T. 1S R. 37E No. 3-1 Cor. Sec. Mer. Will State Ore N. F. Umatilla Dist. Pend.

2. Corner Status

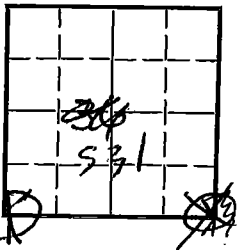

3. Original Description _____ Vol. _____ Page _____ Where Recorded _____

4. Description of Corners: A pine 8" dia. for closing cor. marked CC 237 E on E T2S S6 and S and T1S S 31 on N faces with broches on the NE & S faces from which a Pine 7" dia. bears N 70° E 40 lks marked T1S 237E531BT A pine 4" dia. bears S 23° 7 lks marked T2S R37E S6 BT.

See T2S R36E

5. Investigation Notes:

By compass & pacing from various other corners w located a piece of rotted down tree marked 237 on one face and S31 on one face. No other legible markings.

No other evidence.

this is corner

Piece of corner tree

| 531 — CC
 | 56
 T1S R37E
 T2S R37E DLY



7. Photo Identification

Photo No. _____
Ident. By: _____

8. Plane Coordinate Position Data

State _____ Zone _____
X _____
Y _____

Estab. By _____
Field Book No. _____
Where Filed _____

9. Evaluation

Authentic _____
Needs Verif. Monument No
Re-estab. _____ Survey _____
Land Status _____

6. Signed _____ Title _____ Date _____

PERPETUATION RECORD

10. Monument:

11. Accessories

Field Book _____ Page _____

12. Set By _____ Title _____

License _____ Agency _____ Date _____

13. Recorded By: _____ Volume _____ Page _____
(Agency)

(Date) (City) (County) (State)

14. Remarks:

Z-25