

OREGON CORNER RESTORATION FORM

SECTION 36 TOWNSHIP 3N RANGE 27E

Z-25

COUNTY: UMATILLA DATE 6/90

CORNER DESIGNATION

SE Corner

CONDITION REPORT ONLY
 NOT FOUND
 RENEWED
 UNRECORDED
 SURVEYED IN
 REFERENCED OUT

PREVIOUS RENEWALS/SURVEYS, ETC.

In May 1940 Otis Gould did a Dependent Resurvey of the Township and set a 1 3/4" OD iron pipe with a 2 1/2" BC at this corner and a WC of same dimensions S 45 W 70 lks.

MONUMENTS & ACCESSORIES FOUND: Condition and Source
 Found WC lying loose on the ground.

MONUMENT DETAIL

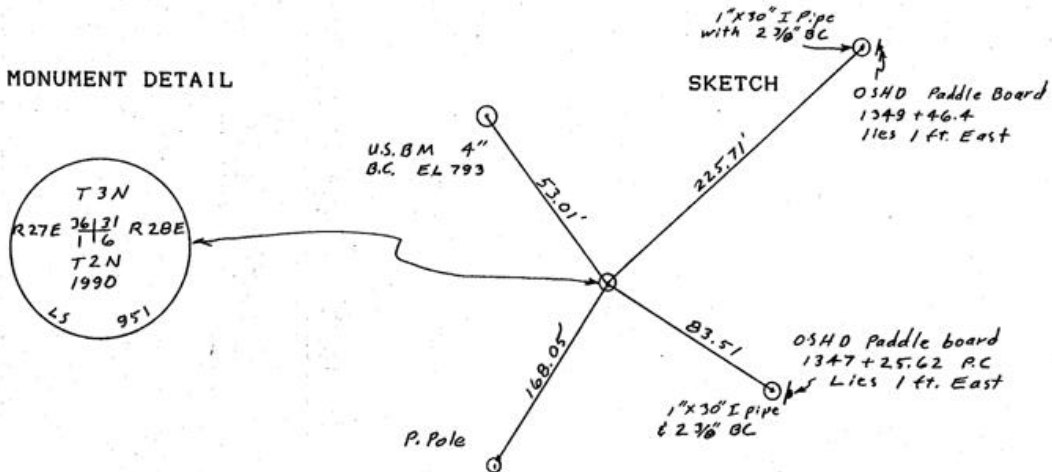

MONUMENT SET (PROCEDURES AND DESCRIPTION)

By retracing Goulds 1940 Survey I set a 1" x 30" I pipe with a 2 3/8" BC stamped as above inside a monument box in the new pavement. See Co. Survey # 90-53-A

NEW ACCESSORIES from which

1"x30" I. pipe with 2 3/8" brass cap bears N46° 10' 30" E 225.71 feet. Unrelated OSHD paddle board is 1 foot east.
 1"x30" I. pipe with 2 3/8" brass cap bears S 58° 41' E 83.51 feet. Unrelated OSHD paddle board is 1 foot east.
 alum. tag in P. pole bears S 30° 50' 10" W 168.05 feet.
 US BM 4" BC bears N 37° 26' 20" W 53.01 feet.

LOCATION & COMMENTS

From intersection of Echo Hwy and Butter Cr. Hwy. go SWly 1.6 miles to corner. (Gravel Rds go W & N)

COMPASS DEC.
 FIRM EDWARDS SURVEYING
 P.O. BOX 763, HERMISTON,
 OREGON, 97838
 PARTY CHIEF D. EDWARDS
NOTES
 WITNESS J. COPPOCK

SURVEYOR'S SEAL

REGISTERED
 PROFESSIONAL
 LAND SURVEYOR

G. Dennis Edwards

OREGON
 JULY 16, 1971
 G. DENNIS EDWARDS
 951

RECEIVED BY

Umatilla County Surveyor

Date 7-90

Rec'd By KA

No. 90-53-A