

**OREGON CORNER RESTORATION FORM**

SECTION: 19 TOWNSHIP: 2N RANGE: 29E N-1

COUNTY: UMATILLA DATE: 6/2010

**CORNER DESIGNATION**

NW 19

- CONDITION REPORT ONLY
- NOT FOUND
- RENEWED
- UNRECORDED
- SURVEYED IN
- REFERENCED OUT

**PREVIOUS RENEWALS/SURVEYS ETC.**

Originally surveyed by Thompson under Contract #83 in 1859. He set post and made mound. In 1980 Terry Hamby set a 2 1/2" brass cap.

**MONUMENTS AND ACCESSORIES FOUND: CONDITON AND SOURCE**

Found Hamby's 2 1/2" brass cap.

**MONUMENT DETAIL**

	T2N	
R28E		R29E
	13   18	
	24   19	
	1980	
PLS	1638	

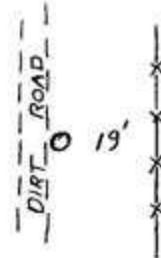

**OREGON STATE PLANE COORDINATES NORTH ZONE, NAD 83(91), Int Feet:**

723966.16  
8522146.92

**MONUMENT SET (PROCEDURES AND DESCRIPTION)**

**NEW ACCESSORIES FROM WHICH**

- A 5/8" x 30" Iron Rebar with plastic cap #951 bears N 78° 16' 05" E 19.48'
  - A 5/8" x 30" Iron Rebar with plastic cap #951 bears N 18° 54' 18" E 52.31'
  - A 5/8" x 30" Iron Rebar with plastic cap # 951 bears N 89° 27' 54" W 13.24'
  - A 5/8" x 30" Iron Rebar with plastic cap # 951 bears S 4° 24' 34" E 331.13'
- These bearings and distances are State Plane.

**LOCATION AND COMMENTS**

From the intersection of Vey Road with Whitehouse Road go south along Whitehouse Road and along a dirt road 3 miles to corner. Corner lies on the east edge of a dirt road.

FIRM: EDWARDS SURVEYING LLC  
PO BOX 763 - HERMISTON OR 97838

PARTY CHIEF: G. EDWARDS  
WITNESS: R. SMITH

SURVEYOR'S SEAL

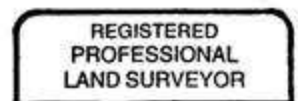

*G. Dennis Edwards*

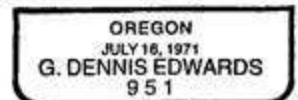

RENEWS 12/31/11