

**OREGON CORNER RESTORATION FORM**

SECTION: 30 TOWNSHIP: 2N RANGE: 29E R-1

COUNTY: UMATILLA DATE: 6/2010

**CORNER DESIGNATION**

NW 30

     CONDITION REPORT ONLY  
     NOT FOUND  
  X   RENEWED  
     UNRECORDED  
     SURVEYED IN  
  X   REFERENCED OUT

**PREVIOUS RENEWALS/SURVEYS ETC.**

Originally surveyed by Thompson under Contract #83 in 1859. He set post and made mound.  
In 1980 Terry Hamby set a 2 1/2" brass cap.

**MONUMENTS AND ACCESSORIES FOUND: CONDITON AND SOURCE**

Found Hamby's 2 1/2" brass cap.

**MONUMENT DETAIL**

T2N  
R28E R29E  
24 | 19  
25 | 30  
1980  
PLS 1638

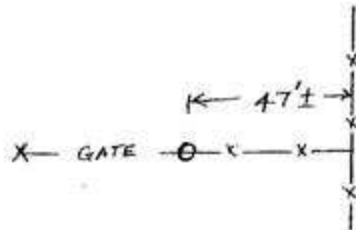

**OREGON STATE PLANE COORDINATES NORTH ZONE, NAD 83(91), Int Feet:**

718671.76  
8522221.92

**MONUMENT SET (PROCEDURES AND DESCRIPTION)**

**NEW ACCESSORIES FROM WHICH**

A 5/8" x 30" Iron Rebar with plastic cap #951 bears N 45° 24' 45" E 66.40'  
A 5/8" x 30" Iron Rebar with plastic cap #951 bears N 89° 49' 16" W 31.77'  
A 5/8" x 30" Iron Rebar with plastic cap # 951 bears S 78° 42' 41" E 41.09'  
A 5/8" x 30" Iron Rebar with plastic cap # 951 bears S 56° 45' 34" E 13.76'  
These bearings and distances are State Plane.

**LOCATION AND COMMENTS**

From the intersection of Vey Road with Whitehouse Road go south along Whitehouse Road and along a dirt road 4 miles to corner. Corner lies in a fence line about 47' west of a fence corner.

SURVEYOR'S SEAL

FIRM: EDWARDS SURVEYING LLC  
PO BOX 763 - HERMISTON OR 97838

PARTY CHIEF: G. EDWARDS  
WITNESS: R. SMITH

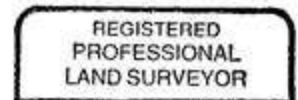

*G. Dennis Edwards*

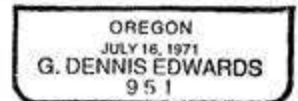

RENEWS 12/31/11