

OREGON CORNER RESTORATION FORM

T2N R29E A1

Section 6, Township 2N, Range 29E,
 County Umatilla, Date June 24, 2004.

- Condition Report
- Not Found
- Remonumented
- Unrecorded
- Surveyed in
- Referenced out

Township corner common to Townships 2 and 3 North
 Ranges 28 and 29 East, W.M., Umatilla County, Oregon.

Previous Renewals / Surveys, etc.

The corner was originally set by David P. Thompson under Contract No. 83 dated July 22, 1859. His record Reads: Set post for corner to Townships 2 & 3 North of Ranges 28 and 29 East in mound of earth &c as per instructions. Surveyor Wayne Harris, under County Survey Q-1655-B, reports finding a "stone w/cross". The owner of the adjacent Eagle Ranches property, Mr. Prior, told me that he was present when Mr. Don Staebler found this stone but did not know who set it. Mr. Prior said the current road to the west was moved to align with the stone in the early 1970's by agreement with the Vey Ranches.

Monument and accessories found: (Condition and source)

I found a basalt stone 12" x 21" x 9" with a "+" on top buried flush with the surface of the ground. A recent survey lath marked "S.E. corner S36" was driven along side.

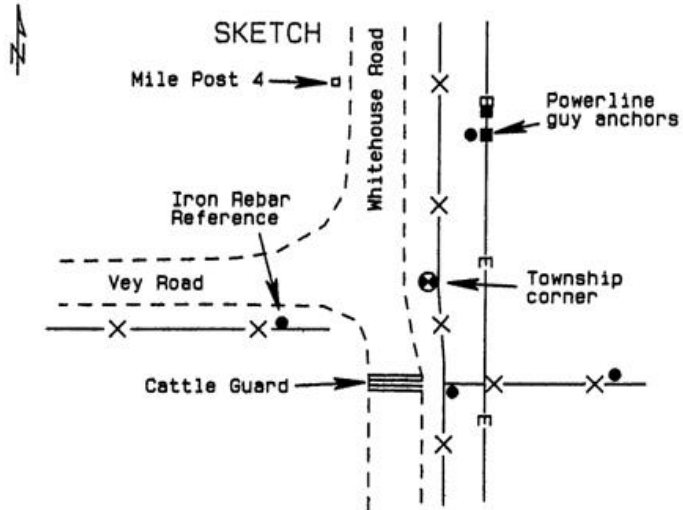
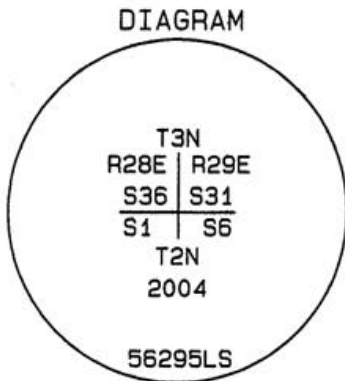

Monument and accessories set: (Procedures and description)

I set a 2 3/8" brass cap on a 30" x 1 3/8" O.D. galvanized iron pipe 30" in the ground with the stone buried at the base of the monument. The cap was stamped as shown in the diagram above.

For references I set four 5/8" x 24" iron rebars with 1.25" orange plastic caps stamped WTS and 56295LS:
 an iron rebar bears N0°18'31"E 96.23 feet;
 an iron rebar bears S66°43'38"W 52.89 feet;
 an iron rebar bears S6°20'29"E 47.40 feet;
 an iron rebar bears S47°57'06"E 64.50 feet;
 the marker paddle for Mile Post #4 on Whitehouse Road bears N13°50'W 181 feet;
 The monument and references were tied with a Trimble R7/R8 system using static surveying procedures. Bearings are grid.

Location and Comments
 SPC Oregon North, NAD 83-91
 Northing = 739,849.13 ift
 Easting = 8,521,921.90 ift

Compass Declination

Surveyor's Seal

Witnessed By:
 RECEIVED BY:
Umatilla County Surveyor
 Date: 5-05
 Rec'd By: KK
 No. 05-111-C

Firm / Agency
 Witness Tree Surveying
 P.O. Box G
 Pilot Rock, OR 97868
 Party Chief
 Stephen K. Haddock, PLS

REGISTERED
 PROFESSIONAL
 LAND SURVEYOR

Stephen K. Haddock

OREGON
 JULY 9, 2001
 STEPHEN K. HADDOCK
 56295LS

RENEWAL DATE 6-30-05