

OREGON CORNER RESTORATION FORM

Section 36 Township 3N
County Umatilla Date: 01/15/11

Range 29E

Corner Designation: 3N29Z25

Corner common to sections 36, T3NR29E, 31, T3NR30E,
1, T2N29E, 6, T2N30E.

- Condition Report Only
- Not Found
- Remonumented
- Unrecorded
- Surveyed In
- Referenced Out

Previous Renewals / Surveys, etc.

Originally Surveyed by David P. Thompson. He set a post in a mound of earth with pits.
S. Haddock set a 1 3/8" x 30" galvanized iron pipe and 2 3/8" Brass cap.

Monuments and Accessories Found: (Condition and Source)

- A 2 3/8" Brass cap approximately 24" below the surface, in good condition.
- A 1" Iron rebar w/opc 56295LS lies N 42°50'20" E, 243.14', at the base of a power pole.
- A 1" Iron rebar w/opc 56295LS lies N 08°25'55" W, 150.44', at the base of a power pole.
- A 1" Iron rebar w/opc 56295LS lies S 61°43'25" E, 27.54', 2 feet below the surface.
- A 1" Iron rebar w/opc 56295LS lies S 31°35'12" W, 27.71', 2 feet below the surface.

Diagram

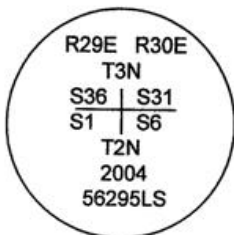

Sketch

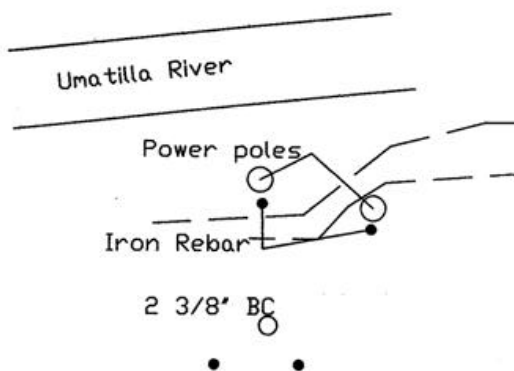

NAD 83/91
OREGON STATE PLANE NORTH
INTERNATIONAL FEET

N740663.73
E8554266.13
LAT - 45° 41' 23.96144" N
LON - 119° 07' 18.58063" W

Monument (s) Set (Procedures and Description)

Revisited corner on January 14, 2011 and found monument lying on top of the ground. Apparent recent trenching from a well North of the corner. Reset monument back to original found position. Hit new 6" pvc water line while digging hole. Scooted hole slightly West and got monument back in with cap at original position. Two angular basalt stones found at base location, 12" below pipe.

References Set:

None

Location and Comments

The corner is South of the Umatilla river and 1/4 mile west of Nolin Oregon.

Compass Declination
17° E

Surveyors Seal

REGISTERED
PROFESSIONAL
LAND SURVEYOR

Robert Douglas English
OREGON
JANUARY 11, 2005
ROBERT DOUGLAS ENGLISH
43406LS

RECEIVED BY:

Firm / Agency

Date: 1-11
Rec'd By: RK
No. 11-31-R

Survey One, LLC.
P.O. Box 382
Pendleton, OR 97801
(541) 276-2055

RENEWAL DATE: 12/31/11