

OREGON CORNER RESTORATION FORM

Section 32 Township 3N
County Umatilla Date: 01/21/10

Range 29E

Corner Designation: 3N29Z9

Corner common to sections 32,33, T3NR29E, 4,5, T2NR29E.

- Condition Report Only
- Not Found
- Remonumented
- Unrecorded
- Surveyed In
- Referenced Out

Previous Renewals / Surveys, etc.

Originally Surveyed by David P. Thompson. He set a post in a mound of earth in 1859.
Survey Q-76-B calls out a fence corner for this location.
Survey I-158-B found a 3/4" Iron pipe and replaced it with a brass cap.
Survey M-16-Ax found a brass cap.

Monuments and Accessories Found: (Condition and Source)

A 2 5/8" Brass cap, in good condition.

Diagram

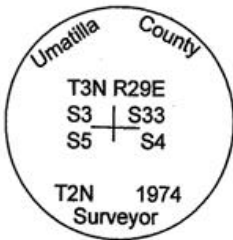

Sketch

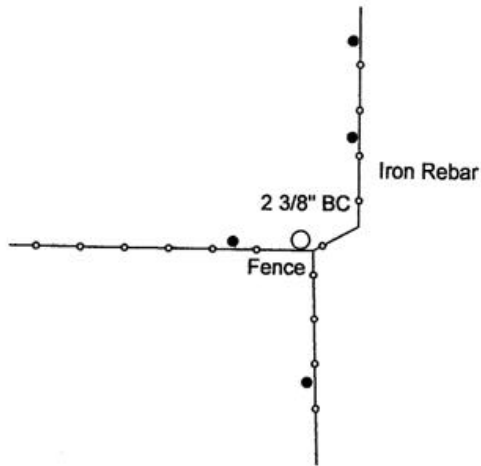

NAD 83/91
OREGON STATE PLANE NORTH
INTERNATIONAL FEET

N740144.49
E8533052.01
LAT - 45° 41' 22.30063" N
LON - 119° 12' 17.51551" W

Monument (s) Set (Procedures and Description)

References Set:

- A 5/8"x30" Iron rebar w/ypc #43406 lies N 30° E, 40.60'.
- A 5/8"x30" Iron rebar w/ypc #43406 lies N 43°30' E, 28.35'.
- A 5/8"x30" Iron rebar w/ypc #43406 lies S 4°30' E, 26.05'.
- A 5/8"x30" Iron rebar w/ypc #43406 lies N 89° W, 15.94'.

Location and Comments

The corner is .5 miles East of the cattle guard at the South end of Snow Road along the East-West fence.

Compass Declination
17° E

Surveyors Seal

REGISTERED
PROFESSIONAL
LAND SURVEYOR

Robert D. English
OREGON
JANUARY 11, 2005
ROBERT DOUGLAS ENGLISH
43406LS

RECEIVED BY:

Date: 1-11
Rec'd By: KR
No. 11-21-R

Firm / Agency

Survey One, LLC.
P.O. Box 382
Pendleton, OR 97801
(541) 276-2055

RENEWAL DATE: 12/31/11