

OREGON CORNER RESTORATION FORM

SECTION: 3 TOWNSHIP: 2N RANGE: 29E C-13

COUNTY: UMATILLA DATE 8/2010

CORNER DESIGNATION

W 1/4 SEC. 3

- CONDITION REPORT ONLY
- NOT FOUND
- RENEWED
- UNRECORDED
- SURVEYED IN
- REFERENCED OUT

PREVIOUS RENEWALS/SURVEYS ETC.

Originally surveyed by Thompson under Contract #83 in 1859. He set post and made mound. In 1962 Wayne Harris Set a 1 1/4" iron pipe in a survey for Pendleton ranch-Cunha ranch.

MONUMENTS AND ACCESSORIES FOUND: CONDITON AND SOURCE

Found 1 1/2" O.D. iron pipe in a north-south fence line

MONUMENT DETAIL

T2N R29E
1/4
4 | 3

OREGON STATE PLANE COORDINATES NORTH ZONE, NAD 83(91), Int Feet:

737652.69
8538402.84

MONUMENT SET (PROCEDURES AND DESCRIPTION)

NEW ACCESSORIES FROM WHICH

A 10" bridge spike & orange mag. 18" deep bears S 87° 56' 51" W 22.08'
A 5/8" x 30" Iron Rebar with plastic cap #951 bears N 0° 14' 56" E 36.87'
A 5/8" x 30" Iron Rebar with plastic cap #951 bears N 87° 12' 08" E 62.96'
A 5/8" x 30" Iron Rebar with plastic cap #951 bears S 1° 04' 11" E 37.50'
These bearings and distances are State Plane.

LOCATION AND COMMENTS

From the intersection of the Heppner to Echo Highway with Snow Road go South on Snow Road 4.1 miles to a fence line. Go East along fence line 1.5 mile to fence corner. Go north along fence 0.5 mile to corner.

SURVEYOR'S SEAL

FIRM: EDWARDS SURVEYING LLC
PO BOX 763 - HERMISTON OR 97838

PARTY CHIEF: G. EDWARDS
WITNESS: R. SMITH

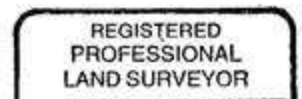

G. Dennis Edwards

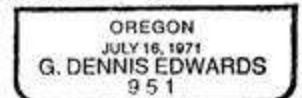

RENEWS 12/31/11