

OREGON CORNER RESTORATION FORM

SECTION: 22 TOWNSHIP: 2N RANGE: 29E R-17

COUNTY: UMATILLA DATE: 6/20/10

CORNER DESIGNATION

SE 22

- CONDITION REPORT ONLY
- NOT FOUND
- RENEWED
- UNRECORDED
- SURVEYED IN
- REFERENCED OUT

PREVIOUS RENEWALS/SURVEYS ETC.

Originally surveyed by Thompson under Contract #83 in 1859. He set post and made mound.

MONUMENTS AND ACCESSORIES FOUND: CONDITON AND SOURCE

Found Fence corner.

MONUMENT DETAIL

T2N R29E
22| 23
27| 26
2008
LS 951

OREGON STATE PLANE COORDINATES NORTH ZONE, NAD 83(91), Int Feet:

719284.98
8544057.33

MONUMENT SET (PROCEDURES AND DESCRIPTION)

At a fence corner I set a 2 3/8" brass cap on a 1" x 30" iron pipe at ground level stamped as above.

NEW ACCESSORIES FROM WHICH

- A 5/8" x 30" Iron Rebar with plastic cap #951 bears N 1° 40' 38" W 42.28'
 - A 5/8" x 30" Iron Rebar with plastic cap #951 bears N 67° 13' 43" E 112.34'
 - A 5/8" x 30" Iron Rebar with plastic cap #951 bears S 0° 22' 48" E 44.24'
 - A 5/8" x 30" Iron Rebar with plastic cap #951 bears S 87° 52' 04" W 37.23'
- These bearings and distances are State Plane.

LOCATION AND COMMENTS

From Cunningham sheep ranch shop go southwesterly on Cunningham Road 2.5 miles to fork. Take left fork South 1 mile to fork. Take right fork South 1.5 mile to fence. Corner is 0.7 mile West.

SURVEYOR'S SEAL

FIRM: EDWARDS SURVEYING LLC
PO BOX 763 - HERMISTON OR 97838

PARTY CHIEF: G. EDWARDS
WITNESS: R. SMITH

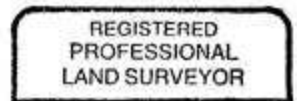

G. Dennis Edwards

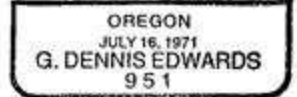

RENEWS 12/31/11