

OREGON CORNER RESTORATION FORM

COUNTY: Umatilla DATE: 01/24/06

CORNER DESIGNATION: 2N31, L1, The West One-Quarter Corner of Section 18.
PREVIOUS RENEWALS/SURVEYS ETC.: Corner established by David P. Thompson, under Contract No. 81, dated July 8, 1859. Record states: Set post for 1/4 Sec. corner and build mound of stone.

J.C. Arnold, in Survey recorded at Book 1, Page 203, states: "the 1/4 sec. cor on E. bndy of said sec. 13 is a stone 16 x 12 x 5 ins. 14 ins. in ground, mkd 1/4 on W. face, set over the charred end of original post in ground 18 ins. at crossing of old fences N & S and E & W".

Surveys by John Kimbrell, recorded in Book 1, Page 550 and Book 1, Page 556, (surveys done in Sept., 1904), both state the corner was recovered, but do not state what existed as a corner monument.

BPA Pendleton-McNary Transmission Line Survey, maps dated 1950, shows corner North 03°08'00" E, 2512.9 feet from the Southwest Corner of Section 18. Maps found in County Assessors Office. BPA maps do not show a coordinate or what was found at this corner—BPA corner position is believed to be a projection, and was not accepted.

MONUMENT AND ACCESSORIES FOUND:

Held the center of a 4 foot diameter mound of stone with remains of a fence extending North and South, as best remaining evidence of the original corner. The 4 foot mound is larger than those North and South of corner point. There are remains of wire in the mounds (or rock jacks), North and South. We found no indications of old fences East or West.

MONUMENT MARKING DETAIL:

T2N
R30E R31E
1/4
S13|S18
2006
PLS 1106

MONUMENT SET:

At the center of the 4 foot diameter mound of stone drove a 5/8" x 24" iron rebar, 10" in the ground to bedrock, placed atop a 2" diameter aluminum cap. Stamped cap as shown in Monument Marking Detail.

A 5/8" x 24" iron rebar with yellow plastic cap stamped "OR PLS 1106, WA PLS 17372", bears North, 58.1 feet.

A 5/8" x 24" iron rebar with yellow plastic cap stamped "OR PLS 1106, WA PLS 17372", bears North 52° East, 59.2 feet.

A 3/4" brass washer stamped "PLS 1106" 1 foot above ground level in the North face of a B.P.A. power transmission pole marked "MCN RND 28 2A BPA" bears, South 25° East, 94.4 feet.

A 5/8" x 24" iron rebar with yellow plastic cap stamped "OR PLS 1106, WA PLS 17372", bears South 17° West, 86.9 feet.

Attached bearing object signs to all rebar accessories. Nailed bearing object sign and witness sign to transmission line pole above brass washer accessory.

LOCATION AND COMMENTS:

Corner is located on West side of ridge top approximately 100' North of B.P.A. transmission line. OREGON STATE PLANE COORDINATE, North Zone, NAD 83(91), International Feet:

N = 728135.44

E = 8586587.03

FIRM: William R. Wells, PLS

P.O. Box 1696

Pendleton, OR 97801

COMPASS DECLINATION: 18° East

Surveyor's Seal

Witnesses: Jason Wells, LSIT

/2N31L1

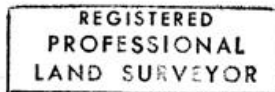

Will R. Wells
OREGON
JULY 22, 1977
WILLIAM R. WELLS
1106

012-462-C