

OREGON CORNER RESTORATION FORM

COUNTY: Umatilla DATE: 01/19/06

CORNER DESIGNATION: 2N31, E-21, The Northeast Corner of Section 11.

PREVIOUS RENEWALS/SURVEYS ETC.: Corner established by Josiah A. Burnett, under Contract No. 92, dated September 12, 1860. Record states: Set a post for corner to Secs. 1, 2, 11 and 12. Drove charred stake and raised mound with trench, as per instructions. Corner was recovered by John Kimbrell in survey recorded at Book 1, Page 359. Kimbrell states: "Original Corner to Secs. 1-2-11-12, Stone, in Md. of Stone". In survey recorded at Book 1, Page 575, John Kimbrell recovers corner but does not state what was recovered..

MONUMENT AND ACCESSORIES FOUND:

Found mound of stone with old downed fences running North, South, East, and West. No marked stone was recovered in the mound of stone. An old abandoned power line running East and West is noted in the area of this corner.

MONUMENT MARKING DETAIL:

T2N R31E
S2|S1
S11|S12
2006
PLS 1106

MONUMENT SET:

Accepted stone mound with old fences North, South, East and West as best remaining evidence of the original corner. At the center of the mound of stone, set a 1 1/4" x 30" galvanized iron pipe with a 2 3/8" brass cap 20" in the ground and rebuilt a 3 foot diameter mound of stone around it. Monument marked as shown in Monument Marking Detail.

A 5/8" x 24" iron rebar with 1 1/4" yellow plastic cap marked "OR PLS 1106, WA PLS 17372", bears North 83° East, 42.0 feet.

A 5/8" x 24" iron rebar with 1 1/4" yellow plastic cap marked "OR PLS 1106, WA PLS 17372", bears South 38° East, 32.1 feet.

A 5/8" x 24" iron rebar with 1 1/4" yellow plastic cap marked "OR PLS 1106, WA PLS 17372", bears South 64° West, 27.3 feet.

A 5/8" x 24" iron rebar with 1 1/4" yellow plastic cap marked "OR PLS 1106, WA PLS 17372", bears North 35° West, 47.6 feet.

Attached bearing object signs to iron rebar accessories. Wired a bearing object sign to fence wire wrapped around a rock 4 feet East of monument for visibility.

LOCATION AND COMMENTS:

Corner is on a rocky scab hillside sloping South and West with old downed fences running North, South, East, and West.

OREGON STATE PLANE COORDINATE, North Zone, NAD 83(91), International Feet:

N = 736207.79
E = 8613097.52

FIRM: William R. Wells, PLS
P.O. Box 1696
Pendleton, OR 97801

COMPASS DECLINATION: 18° East

Surveyor's Seal

Witnesses: Jason Wells, LSIT

/2N31E21

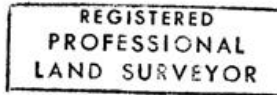

William R. Wells
OREGON
JULY 22, 1977
WILLIAM R. WELLS
1106

renews 6-30-08

172-412-C