

OREGON CORNER RESTORATION FORM

COUNTY: Umatilla DATE: 04/13/06

CORNER DESIGNATION: 2N31, E-3, The South One-Quarter Corner of Section 6.

PREVIOUS RENEWALS/SURVEYS ETC.: Corner established by Josiah A. Burnett, under Contract No. 92, dated September 12, 1860. Record states: Set a post for 1/4 Sec. corner and raised stone mound, as per instructions.

MONUMENT AND ACCESSORIES FOUND: None.

MONUMENT MARKING DETAIL:

T2N R31E
1 S6
4 S7
2006
PLS 1106

MONUMENT SET:

Re-established corner by single proportionate measure between the recovered Northwest corner and reestablished Northeast corner of section 7. At reestablished corner position, set a 2 1/2" brass disk in concrete in a 15"x15"x2" (measured above ground), immovable rock. Monument marked as shown in monument marking detail.

From which:

A 5/8"x24" iron rebar with 1 1/4" red plastic cap stamped "OR PLS 1106 WA PLS 17372" bears North 40 1/2° East, 30.0 feet. Rebar is leaning uphill.

A 5/8"x24" iron rebar with 1 1/4" red plastic cap stamped "OR PLS 1106 WA PLS 17372" bears South 25 1/2° East, 16.7 feet.

"XBO" chiseled in the top of a 15"x12"x18", (measured above ground), immovable rock bears South 24° West, 8.4 feet.

"XBO" chiseled in the top of a 24"x18"x10", (measured above ground), immovable rock bears North 85° West, 18.1 feet.

Attached bearing object signs to rebar accessories.

LOCATION AND COMMENTS: Corner is located on a steep rocky slope with talus rock slides approximately 125 feet North of a drainage flowing Westerly.

OREGON STATE PLANE COORDINATE, North Zone, NAD 83(91), International Feet:

N = 735904.33
E = 8589502.02

FIRM: William R. Wells, PLS
P.O. Box 1696
Pendleton, OR 97801

COMPASS DECLINATION: 18° East

Surveyor's Seal

Witnesses: Jason Wells, LSIT

/2N31E3

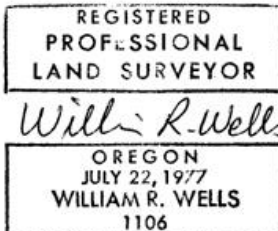

renews 6-30-08

06-462-c