

**OREGON CORNER RESTORATION FORM**

COUNTY: Umatilla DATE: 01/24/06

CORNER DESIGNATION: 2N31, N-9, The Southeast Corner of Section 17.

PREVIOUS RENEWALS/SURVEYS ETC.: Corner established by Josiah A. Burnett, under Contract No. 92, dated September 12, 1860. Record states: Set a post for corner to Secs. 16, 17, 20 and 21. Drove charred stake and raised mound with trench, as per instructions.

Survey No. 03-293-B, PLS 933, states found mound of stone.

**MONUMENT AND ACCESSORIES FOUND:**

Found and held a mound of 4 stones in a slight depression as the best remaining evidence of the original corner. The stones are the only stones in the general area. There is indication of an old fence running East-West through the corner.

**MONUMENT MARKING DETAIL:**

T2N R31E  
S17|S16  
S20|S21  
2006  
PLS 1106

**MONUMENT SET:**

At a point in the center of the 4 stones, set a 1 1/4" x 30" galvanized iron pipe with 2 3/8" brass cap, 20" in the ground and raised a mound of earth and stone to the top of the cap. Monument marked as shown in Monument Marking Detail.

A 5/8" x 24" iron rebar with yellow plastic cap stamped "OR PLS 1106, WA PLS 17372", bears North 65° East, 35.7 feet.

A 5/8" x 24" iron rebar with yellow plastic cap stamped "OR PLS 1106, WA PLS 17372", bears South 31° East, 38.8 feet.

A 5/8" x 24" iron rebar with yellow plastic cap stamped "OR PLS 1106, WA PLS 17372", bears South 58 1/2° West, 46.0 feet.

A 5/8" x 24" iron rebar with yellow plastic cap stamped "OR PLS 1106, WA PLS 17372", bears North 37 1/2° West, 43.9 feet.

Attached bearing object signs to all rebar accessories. Set steel fence post 2 feet North of monument with witness sign attached.

**LOCATION AND COMMENTS:**

Corner is located on the top of a gentle ridge approximately 700 feet North of a B.P.A. power transmission line. The East edge of an old road bed running North-South is 8 feet West of corner.

OREGON STATE PLANE COORDINATE, North Zone, NAD 83(91), International Feet:

N = 725433.39  
E = 8597545.09

FIRM: William R. Wells, PLS  
P.O. Box 1696  
Pendleton, OR 97801

COMPASS DECLINATION: 18° East

Surveyor's Seal

Witnesses: Jason Wells, LSIT

/2N31N9

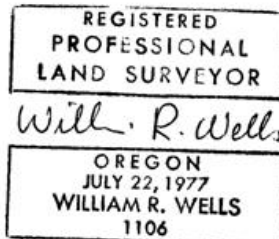

renews 6-30-08

No-4162-C