

**OREGON CORNER RESTORATION FORM**

T1N R31E A1

Section 6, Township 1N, Range 31E,  
County Umatilla, Date December 10, 2004.

- Condition Report
- Not Found
- Remonumented
- Unrecorded
- Surveyed in
- Referenced out

Township corner common to Townships 1 and 2 North  
Ranges 30 and 31 East, W.M., Umatilla County, Oregon.

Previous Renewals / Surveys, etc.

The corner was originally set by David P. Thompson under Contract No. 81 dated July 8, 1859. His record Reads: Set post for corner to Townships 1 and 2 North of Ranges 30 and 31 East and build mound of earth with pits, trench &c., as per instructions. County Surveyor, Geary Kimbrell, ran the centerline of County Road #781 through this corner in his survey dated November 21, 1916. Engineer John Gray, in survey G-51-C, 1956 states: Found Charred Stake.

Monument and accessories found: (Condition and source)  
None.

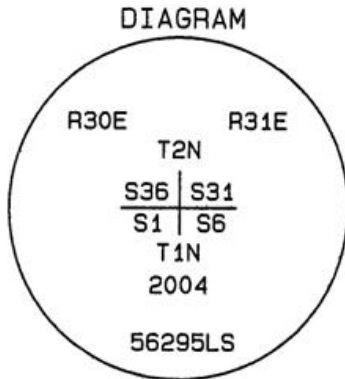

- = Brass Cap
- = Iron Rebar Reference
- = 1" square iron shaft.

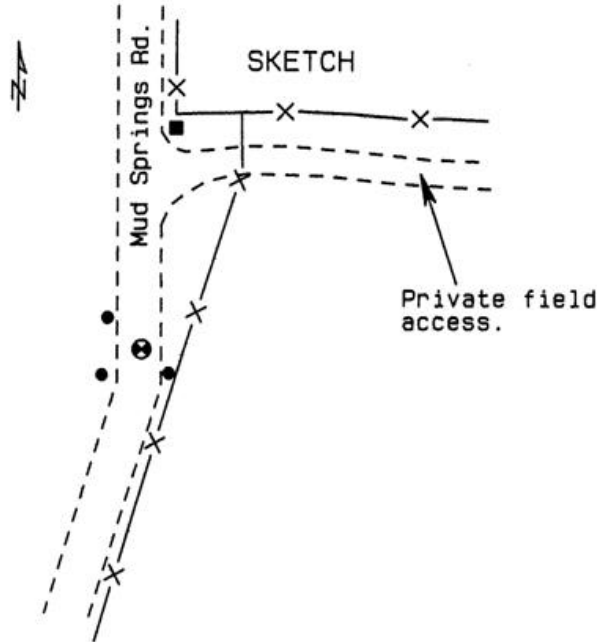

Monument and accessories set: (Procedures and description)

I set a 2 3/8" brass cap on a 23" x 1 3/8" O.D. galvanized iron pipe 33" in the ground to bedrock under the road. The cap was stamped as shown in the diagram above.

For references I set three 5/8" x 24" iron rebars with 1.25" orange plastic caps stamped WTS and 56295LS:

- an iron rebar bears N47°21'41"W 22.98 feet 18" below the surface of a field;
- an iron rebar bears S57°18'47"W 23.47 feet 18" below the surface of a field;
- an iron rebar bears S48°55'19"E 18.04 feet near the right of way fence;
- a 1" square iron shaft with an "x" cut in the top of unknow origin bears

N8°36'48"E 109.86 feet near a railroad tie fence corner.  
Survey control was established using a Trimble R7/R8 GPS and static surveying procedures. The monument and references were set using a Trimble 5601 Robotic total station and radial methods. Bearings and distances are Grid.

Location and Comments  
SPC Oregon North, NAD 83-91  
Northing = 709,578.47 ift  
Easting = 8,586,723.82 ift

Compass Declination

Surveyor's Seal

Witnessed By:  
RECEIVED BY:  
Umatilla County Surveyor  
Date: 5-05  
Rec'd By: KK  
No. 05-111-C

Firm / Agency  
Witness Tree Surveying  
P.O. Box G  
Pilot Rock, OR 97868  
Party Chief  
Stephen K. Haddock, PLS

REGISTERED  
PROFESSIONAL  
LAND SURVEYOR

*Stephen K. Haddock*

OREGON  
JULY 9, 2001  
STEPHEN K. HADDOCK  
56295LS

RENEWAL DATE 6-30-05