

Form 874-9—Revised May, 1918

U. S. Department of Agriculture

FOREST SERVICE

Omatilla

NATIONAL FOREST

CORNERS OF THE PUBLIC SURVEY

T. *2 N* R. *36 E* W. Mer.

Section 11 Corner common to Sections

11, 12, 13, and 14

Corner consists of a *mound of rocks* (not) in place

State condition *good*

Dimensions above ground _____ inches.

Sketch grooves, letters, figures, or notches, on proper face or edge.

CARDINAL POSITION

DIAGONAL POSITION

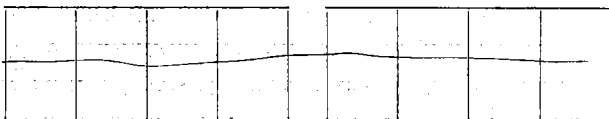

Mound of _____ is located _____

Pits are located _____

Sketch markings of Bearing Trees (or Rocks) in proper box and fill blanks below, giving bearings from Corner to Trees and Distances in Links.

*T. 2 N
R. 36 E
S-11*

*T. 2 N
R. 36 E
S-13*

BT

BT

Species *D.F.* *D.F.* _____

Diameter *26"* *28"* _____

Bearing *N45 W.* *S. 38 E.* _____

Distance *10 ft.* *10 ft.* _____

Do you believe this to be a genuine Land Office Corner? *yes*

If not, why? _____

F. D. Wilmoth

(Signature)

Ass't Ranger.

6-7-32

(Date)

(Title)

T. 2 N R. 36 E W Mer.

(Make sketch of topography near Corner)

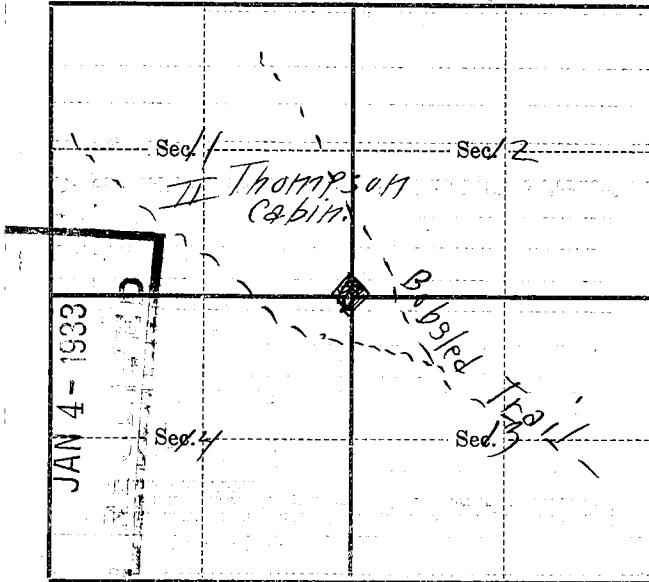

Metal Location Poster is on a Douglas Fir tree 36 inches diameter, on the South East side of Sec. corner from which this Corner bears N. 45° West, 10 ft chains distant.

Give any further facts which will aid in finding this Corner again.

A section line board is mounted on a post on the Bobbed nail 35 ft. south of this corner.

Index

File No. J-21

CORNER RECORD (SEARCH)

(Ref. FSM 7151.4)

Tractor

Survey No. _____

Cor.

No. _____

T 2N R. 36E

R.D. Pendleton

County Umatilla

Merid. Wm.

N.F. Umatilla

State Oregon

CORNER DIAGRAM

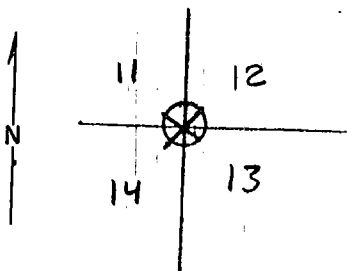

DESCRIBE CORNER MONUMENT FOUND

Stone was found. It had apparently been turned, as notches were not as described.

DESCRIBE BEARING TREES OR OTHER OFFICIAL ACCESSORIES FOUND

PHOTO IDENTIFICATION DATA

Photo No. _____

Filed At. _____

Object Ident. _____

Ident. By _____

Signature

PLANE COORDINATE POSITION DATA

State _____ Zone _____

Estab. By _____

Agency

DESCRIBE CORNER LOCATION RELATIVE TO NEAR-BY FEATURES, ALSO HOW TO REACH CORNER

Corner is about one chain west of Bobsted Jeep Road and is visible from road. Location is about 10 chains north of Bobsted Rain gauge and snow marker.

Signature

Ronald S. Hardner

Title

Forester

Division

TM

Headquarters

Pendleton

Date

9-10-72

J-21

CORNER RECORD (PERPETUATION)

TRN R36E

MONUMENT: DESCRIBE NEW MONUMENT SET, OR WORK DONE TO PRESERVE EXISTING MONUMENT

All bearing trees found and painted with a band of red paint. Red paint also put on corner stone.

9

ACCESSORIES : DESCRIBE NEW BT'S WITNESS OBJECTS ETC. ESTABLISHED, OR WORK DONE TO PRESERVE EXISTING EVIDENCE

10

Work Done By _____ Title _____ Date _____ State Registration No. or Agency _____

Certified Cor. Record Prepared ? Yes No Filed At: _____ Date _____

11

REMARKS

12

Index File No. T. B. M. Tract or Surv. No. Cor.