

CERTIFIED RECORD OF LAND CORNER MONUMENTATION

A-11

History of original corner establishment:

In Sept. 1882 Deputy Herman D. Gradon under contract No. 452.

Set a Basalt stone 14"x10"x8"-9" in ground marked 1/4 on North face and raised mound of stone along side.

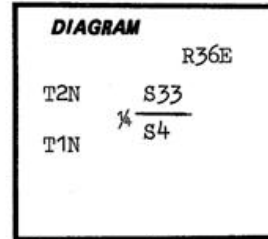

A-11

Description of corner evidence found:

Stone 14"x8"x6" marked 1/4 on North face firmly set in a mound of stone 36" in diameter, 8" high.

Description of monument and accessories I established to perpetuate the original location of this corner:

Set 2 1/2"x30" Aluminum pipe with a 2 1/2" Aluminum cap 4" in ground. Built mound of stone 4 ft. base 26" high.

Stamped:

R36E

T2N 1/4 S33

T1N S4

1983

PLS 896

Accessories:

Set 5/8"x30" Iron rod with a red plastic cap stamped PLS 896 N5E-71.2 feet.

Set 5/8"x30" Iron rod without red plastic cap S20W-23.5 feet.

Set guard post North with sign 54-4 only.

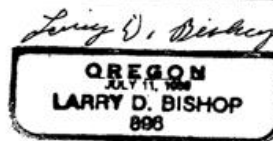
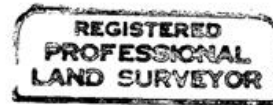

Office of Surveyor County of Umatilla
 State of Oregon I hereby certify that the within instrument was filed in this office
 for record on the 27th day of October, 1983
Daniel Krumbein by Betty Cochran
 (COUNTY OFFICIAL) (DEPUTY)

RECEIVED BY
 Umatilla County Surveyor
 Date _____
 Rec'd By _____
 No. 83-181-R