

Form 874-9

U. S. DEPARTMENT OF AGRICULTURE  
FOREST SERVICE



Yosemite NATIONAL FOREST

CORNERS OF THE PUBLIC SURVEY

T. 27 R. 37 E. 11 Mer.

Section Corner common to Sections  
24 and 25

DESCRIPTION OF CORNER

Corner consists of a Rock

Dimension above ground 4" x 10" inches.  
Sketch grooves, letters, figures, or notches, on proper face or edge.

CARDINAL POSITION

DIAGONAL POSITION

<u>1/4</u>			
N	W	S	E

NW	SW	SE	NE

Mound of \_\_\_\_\_ is located \_\_\_\_\_

Pits are located \_\_\_\_\_

Sketch markings of Bearing Trees (or Rocks) in proper box and fill blanks below, giving bearings from Corner to Trees and Distances in Links.

	<u>1/4 S</u>		
	<u>137</u>		

Species Juniper

Diameter 2.0

Bearing S 45 W

Distance 6.5

Do you believe this to be a genuine Land Office Corner? Yes

If not, why? \_\_\_\_\_

George J. ...

Signature

9-25-50  
Date

Title

T. 21 R. 37 SW Mer.

8-3027

(Make sketch of topography near Corner.)

FOREST SERVICE  
UNITED STATES NATIONAL FOREST  
PENDLETON, OREGON  
FEB 20 1934  
RECEIVED  
Answered

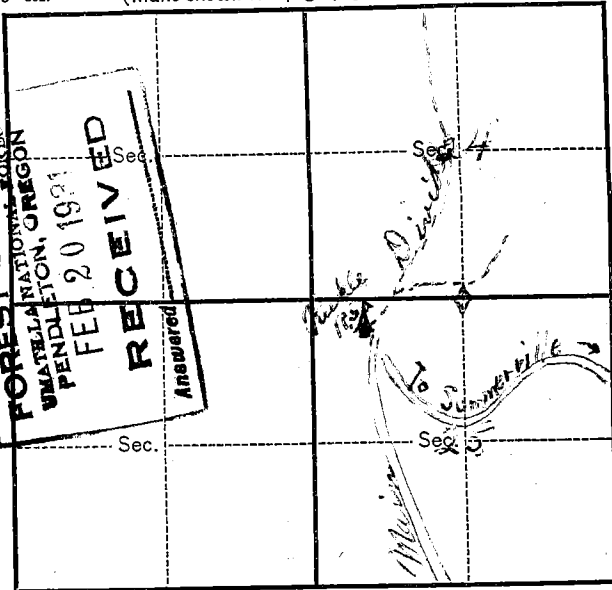

Metal Location Poster is on a brush  
tree 30 inches diameter, on the East side  
side of 1/4 corner  
from which this Corner bears Due west  
45 ft chains distant.

Give any further facts which will aid in finding this  
Corner again.

Advent Valley was Pine  
timber and all of timber  
going to the side of the  
mountain. The other trees are  
gone and some brush is  
about 100 yards from trail  
between trees is plain