

U. S. DEPARTMENT OF AGRICULTURE
FOREST SERVICE

Umatilla NATIONAL FOREST

CORNERS OF THE PUBLIC SURVEY

T. 2-37 R. 38 E N Mer.

Section Corner common to Sections

33, 34, 3, and 4

Corner consists of a Stake (not) in place

State condition Rotted pland rock
where stake rotted off.

Dimensions above ground 10 inches.

Sketch grooves, letters, figures, or notches, on proper face or edge.

CARDINAL POSITION

DIAGONAL POSITION

N	W	S	E

R38E	R38E	T37N	T37N
S	S	R38E	S34
33	4	S 3	
NW	SW	SE	NE

Mound of _____ is located _____

Pits are located _____

Sketch markings of Bearing Trees (or Rocks) in proper box and fill blanks below, giving bearings from Corner to Trees and Distances in Links.

T37N R38E S33	<u>Overgrown</u>	<u>Overgrown</u>	T37N R38E S34
			BT

Species W.? W.? W.? W.?
 Diameter 36" 16" 16" 16"
 Bearing N43W S18W S22E N81E
 Distance 32 Pks 56 Pks 20 Pks 16 Pks

Do you believe this to be a genuine Land Office Corner? Yes

If not, why? _____

Signature.

8-11-31
Date.

Title

T. 2-3-27 R. 38 E. W. Mer.

8-3027

(Make sketch of topography near Corner.)

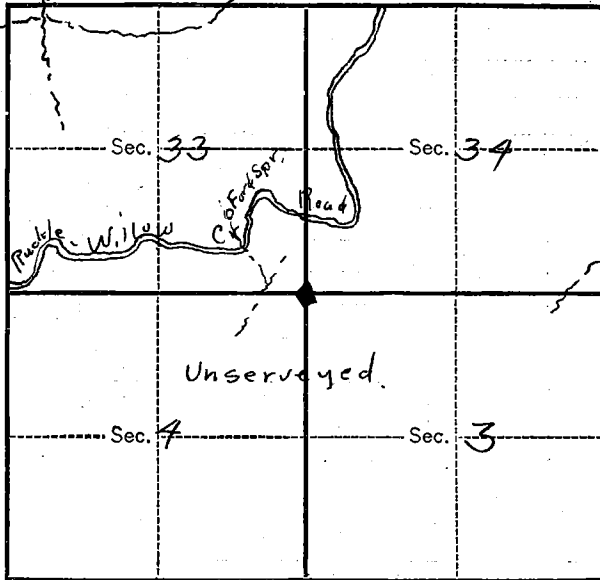

Metal Location Poster is on a W 7
tree 16 inches diameter, on the NW
side of tree
from which this Corner bears N 22 W
20 links distant.

Give any further facts which will aid in finding this
Corner again.

Corner is found in W 7.
tree on a moderate
southwest slope 19
chains south of road.
A survey tag and
section line sign board
are placed on south side
of road due north of
corner