

Form 874-9—Revised May, 1918

U. S. Department of Agriculture

FOREST SERVICE

Umatilla NATIONAL FOREST

CORNERS OF THE PUBLIC SURVEY

T. *2 N* R. *38 E* W. Mer.

Section *6* Corner common to Sections *6* and *7*

Corner consists of a *Stake rotted* (not) in place
State condition *and gone.*

Dimensions above ground _____ inches.

Sketch grooves, letters, figures, or notches, on proper face or edge.

N	W	S	E

NW	SW	SE	NE

Mound of _____ is located _____

_____ Pits are located _____

Sketch markings of Bearing Trees (or Rocks) in proper box and fill blanks below, giving bearings from Corner to Trees and Distances in Links.

			<i>T2N</i>
			<i>R38E</i>
			<i>S6</i>
			<i>137</i>

Species _____ *D.F.*

Diameter _____ *36*

Bearing _____ *?*

Distance _____ *?*

Do you believe this to be a genuine Land Office Corner? *Yes*

If not, why? *Corner was probably a stake and has been destroyed by the elements*

Qually J. Tucker
(Signature)

9-24-30

(Date)

Forest Ranger
(Title)

T. 2 N R. 38 E W Mer.

(Make sketch of topography near Corner)

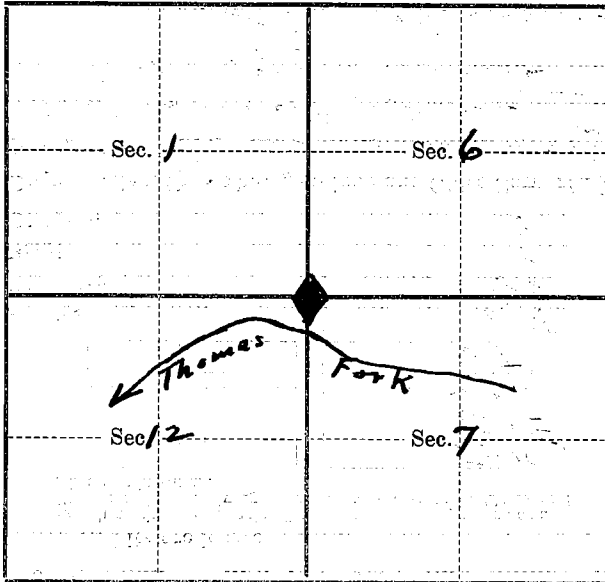

Metal-Location Poster is on a D.F.
tree 36 inches diameter, on the NE
side of corner
from which this Corner bears approx. S 40 W
one chains distant.

Give any further facts which will aid in finding this
Corner again.

On Township line between
Township 2 North, Ranges
37 and 38 E W, M. Near head
of Thomas Fork. On north
side of creek about 20 rods
Open slope with Y.P. and
D.F. trees scattered thereon.