

Form 874-9

U. S. DEPARTMENT OF AGRICULTURE
FOREST SERVICE

Umatilla NATIONAL FOREST

CORNERS OF THE PUBLIC SURVEY

T1N & 2N R. 38 E W Mer.
Quarter Corner common to Sections

6 and 31

DESCRIPTION OF CORNER

Corner consists of a Stake rotted

Dimension above ground _____ inches.
Sketch grooves, letters, figures, or notches, on proper face or edge.

CARDINAL POSITION

DIAGONAL POSITION

N	W	S	E

NW	SW	SE	NE

Mound of _____ is located _____

Pits are located _____

Sketch markings of Bearing Trees (or Rocks) in proper box and fill blanks below, giving bearings from Corner to Trees and Distances in Links.

T	$1\frac{1}{4}$ N
---	---------------------

--

$1\frac{1}{4}$

--

--

--

--

--

Species D F Cottonwood

Diameter 40 in 16"

Bearing Corner in middle of road

Distance according to Bearing Trees.

Do you believe this to be a genuine Land Office Corner? Yes

If not, why? _____

Quall J. Fisher
Signature

Aug. 11, 1927
Date.

Forest Ranger
Title.

T. 1N & 2N R. 38 E W Mer.

8-3027

(Make sketch of topography near Corner.)

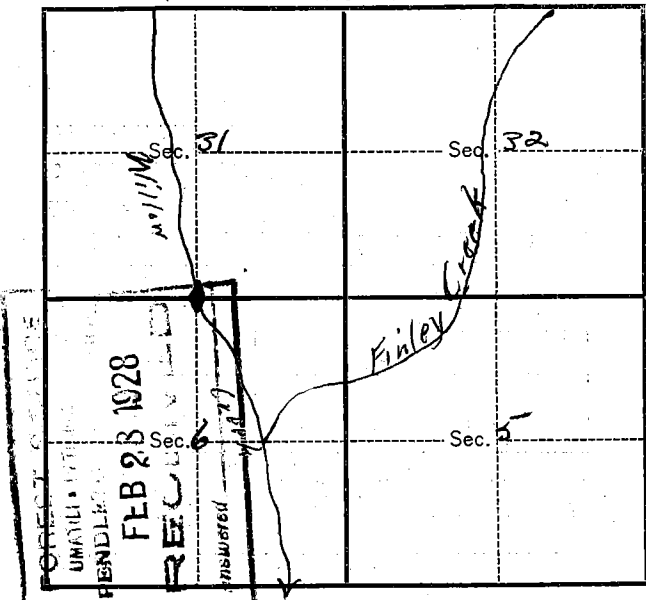

Metal Location Poster is on a Cottonwood
tree 16 inches diameter, on the East
side of Thomas and Ruckel road
from which this Corner bears (Approx. ~~3000~~ West
15 ft.) ~~7000~~ distant.

Give any further facts which will aid in finding this
Corner again.

About one half mile above the
mouth of Finley Creek on the
Thomas & Ruckel road which runs
up Willow Creek. Cottonwood tree
is on east side of road and the
large D F tree is on the west
side. Location, a flat open
glade, rather small, on the Cr.
bottom.

Form 874-9—Revised May, 1918

U. S. DEPARTMENT OF AGRICULTURE
FOREST SERVICE

Umatilla NATIONAL FOREST

CORNERS OF THE PUBLIC SURVEY

T. 2 N R. 38 E Mer.

1/4 Corner common to Sections

On township line on South line Sec 31.

Corner consists of a Rock (not) in place

State condition Good

Dimensions above ground 10" x 12" x 8" inches.

Sketch grooves, letters, figures, or notches, on proper face or edge.

CARDINAL POSITION

DIAGONAL POSITION

N	W	S	E

NW	SW	SE	NE

Mound of _____ is located _____

Pits are located _____

Sketch markings of Bearing Trees (or Rocks) in proper box and fill blanks below, giving bearings from Corner to Trees and Distances in Links.

<u>1/4 C</u>		<u>Grown Over</u>	
<u>B.T.</u>			

Species Brake W.F.

Diameter 20" 22"

Bearing N. 12 W S 32 E

Distance 17 lks. 37 lks.

Do you believe this to be a genuine Land Office Corner? Yes

If not, why? _____

Gerald J. Fisher
Signature

May 11/33 Forest Ranger
Date Title

T. 2 N R. 38 E.W. Mer.

8-3027

(Make sketch of topography near Corner.)

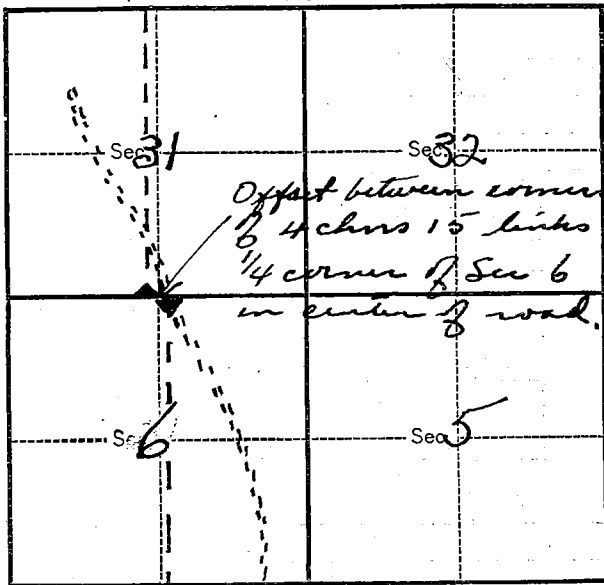

Metal Location Poster is on a White Fir
tree 22 inches diameter, on the South
side of Corner
from which this Corner bears N. 32 W
37 links ~~or~~ distant.

Give any further facts which will aid in finding this
Corner again.

4 chrs 15 links west of
Willow Creek road, at
Posted line between private
land and N. F. land.

USDA-FOREST SERVICE

Index

File No. A-3

T 1N R. 38E

Merid. Willamette

CORNER RECORD (SEARCH)

(Ref. FSM 7151.4)

R.D. Walla Walla County

N.F. Umatilla State Oregon

Tract or

Survey No. _____

Union _____

Cor.

No. _____

CORNER DIAGRAM

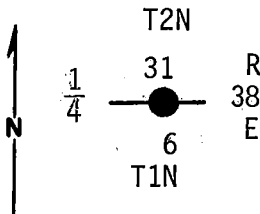

DESCRIBE CORNER MONUMENT FOUND

None

DESCRIBE BEARING TREES OR OTHER OFFICIAL ACCESSORIES FOUND ²

We establish the True Corner Point in the following relationship to the original bearing trees: An orig. 26" Tamarack, now down and badly rotted, with scribing " $\frac{1}{4}$ SBT" visible on an unhealed double blaze, bears N20W 6.6 ft., and an orig. 12" Fir, now a 34" Grand Fir, alive and in good condition, no markings visible, bears S270E 28.3 ft.

PHOTO IDENTIFICATION DATA

Photo No. F166161601577-123

Filed At. Umatilla Nat. For

Object Ident. Direct

Ident. By G. Langlitz

Signature

6

7

PLANE COORDINATE POSITION DATA

State _____ Zone _____

X _____

Y _____

Estab. By _____
Agency

8

DESCRIBE CORNER LOCATION RELATIVE TO NEAR-BY FEATURES, ALSO HOW TO REACH CORNER ³

Corner located approx. 300 ft. west of Road No. 3200

Gary A. Langlitz
Signature

Title Land Surveyor

Division PLS1099

Headquarters _____

Date 9-29-80

7100-52-(3,68)

4

5

CORNER RECORD (PERPETUATION)

MONUMENT: DESCRIBE NEW MONUMENT SET, OR WORK DONE TO PRESERVE EXISTING MONUMENT

At the True Corner Point, we set a 2"x30" Galvanized Iron Pipe, 27" in the ground on a slight east hillside, with brass cap attached marked;

T2N
R ~~S31~~ 1/4
38 ~~S 6~~
E T1N
PLS1099
1980

ACCESSORIES: DESCRIBE NEW BT'S, WITNESS OBJECTS ETC. ESTABLISHED, OR WORK DONE TO PRESERVE EXISTING EVIDENCE

From which we mark new BT's: A 12" Grand Fir, scribed "1/4 S31 BT" on a double blaze bears N82 1/2°W 15.6 ft., and a 10" Douglas Fir, scribed "1/4 S6 BT" on a double blaze bears S29°W 17.1 ft. Attached brass washer stamped "LS 1099" to lower blaze of new BT's. Placed steel fencepost 5 ft. east of monument with signs 54-2 and 54-4 attached. Attached signs and painted BT's per Standard Specifications for Cadastral Survey U.S.F.S. Region 6 October 1979

Work Done By Gary Langlitz Title Land Surveyor Date 9-29-80 State Registration No. PLS 1099
or Agency

Certified Cor. Record Prepared? Yes No Filed At: Union County Surveyor Date Dec. 1980

REMARKS

Compass Declination: 20° East

Witness: John Curtiss

USDA-FOREST SERVICE

Index

File No. A-3

T 1N R. 38E

Merid. Willamette

2

CORNER RECORD (SEARCH)

(Ref. FSM 7151.4)

Tract or Survey No. _____ No. _____

R.D. Pendleton County Umatilla

N.F. Umatilla State Oregon

CORNER DIAGRAM

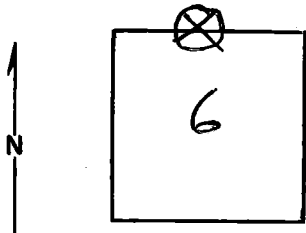

DESCRIBE CORNER MONUMENT FOUND

None.

DESCRIBE BEARING TREES OR OTHER OFFICIAL ACCESSORIES FOUND

26" tam. - NW quadrant, tree is down with blaze facing $\frac{1}{4}$ corner. Blaze is scribed: $\frac{1}{4}$ S T 34" fir - southeast quad. with closed NW blaze and FS location poster dated 1933. Old bdry. sign on tree 10' west of $\frac{1}{4}$ cor.

PHOTO IDENTIFICATION DATA

Photo No. _____

Filed At. _____

Object Ident. _____

Ident. By _____

Signature

PLANE COORDINATE POSITION DATA

State _____ Zone _____

X _____

Y _____

Estab. By _____

Agency

Signature

R. Moore

Title

Eng. Tech.

Division

Headquarters

Date

7/78

7100-52-(3/68)

5

CORNER RECORD (PERPETUATION)

 MONUMENT: DESCRIBE NEW MONUMENT SET, OR WORK DONE TO PRESERVE EXISTING MONUMENT

 ACCESSORIES : DESCRIBE NEW BT'S WITNESS OBJECTS ETC. ESTABLISHED, OR WORK DONE TO PRESERVE EXISTING EVIDENCE

I placed attention and bearing tree posters on the 2 BT's. Also put up location poster on road 300' east.

 Work Done By _____ Title _____ Date _____ State Registration No. or Agency _____

 Certified Cor. Record Prepared ? Yes No Filed At: _____ Date _____

REMARKS

 Index File No.

T.

R.

M.

Tract or Surv. No.

Cor.

13

12

10

9