

OREGON CORNER RESTORATION FORM

Section 1 Township 2S Range 31E
 County Umatilla Date: March 14, 2011

Corner Designation: 2S31C21

Condition Report Only
 Not found
 Remonumented
 Unrecorded
 Surveyed in
 Referenced out

Common quarter corner to sections 1 and 2, T2S, R31E,
 W.M., Umatilla County, Oregon.

Previous Renewals / Surveys, etc.

Corner originally set by Daniel Chaplin under contract No. 107 dated September 21, 1864.
 His record reads: Set post for 1/4 Sec. Cor., in mound of earth, with charred stake, pits, etc. as
 per instructions. Stan Wallulis, in survey Q-883-Ax says: found stone 4x6x10 inches with 1/4
 chiselled on its surface as reset by Nat Kimbrell about 1900. He set 2, 5/8"x30" iron rods, one
 five feet south and one five feet east for references.

Monument and Accessories found: (condition and source)

I found the references set by Stan Wallulis. The corner point now falls in a fence rock jack. I did
 not find the stone.

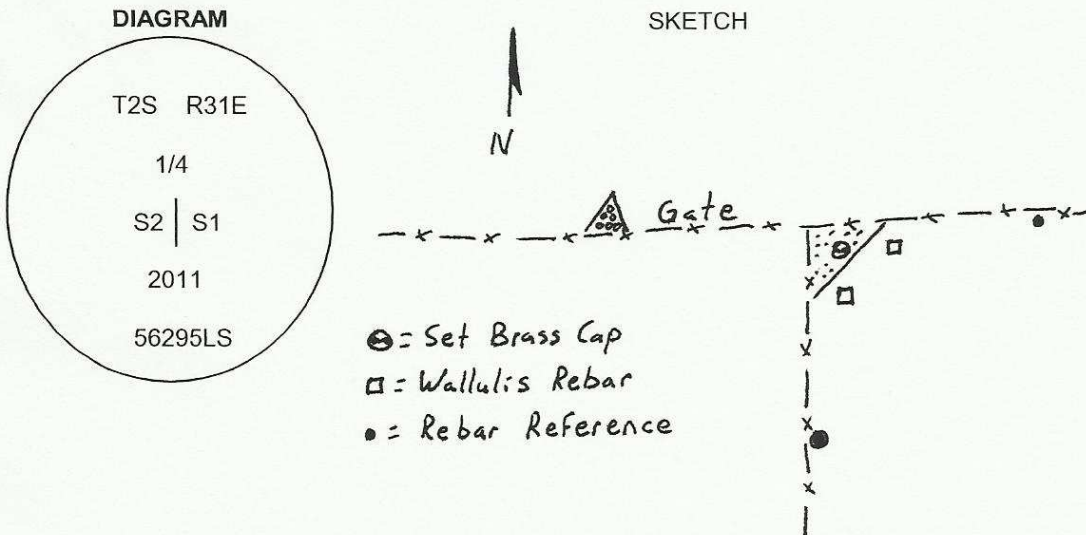

MONUMENT (S) AND ACCESSORIES SET (Procedures and Description)

I set a 1 1/2" x 30" galvanized iron pipe with a 2 1/4" brass cap stamped as shown in the diagram
 above under the rock jack at the position based on the found reference pins.

For references, I set two 5/8" by 24" rebars with 1.25" orange plastic caps stamped WTS and
 56295LS as described below:

- an iron rebar bears N86°23'27"E, 55.93 feet under the existing fence;
- an iron rebar bears S03°33'09"W, 52.83 feet under the existing fence;
- the 5/8" iron rebar by Wallulis bears S00°16'38"E, 5.00 feet;
- the 5/8" iron rebar by Wallulis bears S89°05'46"E, 5.00 feet;

The monument and references were tied using a Trimble R7/R8 RTK GPS system.

Location and comments

Compass Declination

Surveyors Seal

RECEIVED BY:
Umatilla County Surveyor
 Date: _____
 Rec'd By: _____
 No. 11-112-C

Firm / Agency
 Witness Tree Surveying
 Address
 P.O. Box G
 Pilot Rock, OR 97868
 Party Chief
 Stephen K, Haddock

REGISTERED
 PROFESSIONAL
 LAND SURVEYOR

Stephen K. Haddock

OREGON
 JULY 9, 2001
 STEPHEN K. HADDOCK
 56295LS

RENEWAL DATE 6-30-13