

History of original corner establishment:

The original corner was established by Daniel Chaplin on November 19, 1864, under GLO contract No. 107, as follows:

Set a stone 22" x 8" x 5" for the 1/4 section corner.

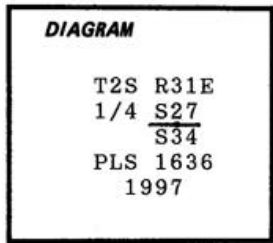

Description of corner evidence found:

The original corner stone is solidly set 4" into the ground with a mound of stones along the south side of the stone. The stone is 16" x 11" x 7" and plainly marked "1/4".

Description of monument and accessories established to perpetuate the original location of this corner:

In place of the stone, I set a 1 1/2" x 30" iron pipe 22" into the ground. A 2 1/2" brass cap attached is marked as shown in the diagram above. I bury the corner stone along the north side of the pipe and build a mound of stones around the pipe to the cap, from which:

A 5/8" x 24" iron rod set 23" into the ground with a 3/4" brass washer, marked "PLS 1636 S27 NE", attached at ground level, bears N56°E, 56.5 feet.

A 5/8" x 24" iron rod set 22" into the ground with a 3/4" brass washer, marked "PLS 1636 S34 SE", attached at ground level, bears S53°E, 49.3 feet.

A 5/8" x 24" iron rod set 20" into the ground with a 3/4" brass washer, marked "PLS 1636 S34 SW", attached at ground level, bears S17°30'W, 69.1 feet.

A 5/8" x 24" iron rod set 23" into the ground with a 3/4" brass washer, marked "PLS 1636 S27 NW", attached at ground level, bears N38°W, 92.6 feet.

I hereby certify the above corner point was perpetuated as hereon described on February 23, 1997. Magnetic declination: 20°E.

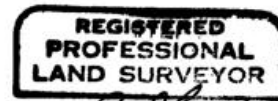

*Dennis L. Gaylord*

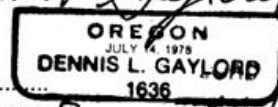

Office of COUNTY SURVEYOR County of UMATILLA  
 State of OREGON, I hereby certify that the within instrument was filed in this office  
 for record on the 23 day of FEBRUARY, 1997.  
*Dennis H. Klein* by Dennis L. Gaylord  
 (COUNTY OFFICIAL) (DEPUTY)

RECEIVED BY  
 Umatilla County Surveyor  
 Date 2-97  
 Rec'd By KK  
 No. 97-27-R