

OREGON CORNER RESTORATION FORM

Section 3 Township 2S Range 32E
 County Umatilla Date: April 25, 1997

Corner Designation: 2S32 E15

1/4 Corner to sections 3, and 10 T2S, R32E W.M.

Condition Report Only
 Not found
 x Remonumented
 Unrecorded
 Surveyed in
 x Referenced out

Previous Renewals / Surveys, etc.

Corner originally set by David P. Thompson under contract No. 106 Dated August 16, 1864.
 Set stone 17 x 10 x 10 for 1/4 section corner.

Monument and Accessories found: (condition and source)

A fence intersection with fences running East, Northwest, and Southwest. The post in the fence corner has a Umatilla County Surveyors Sign on it reporting it to be the corner. There is no date on the sign.

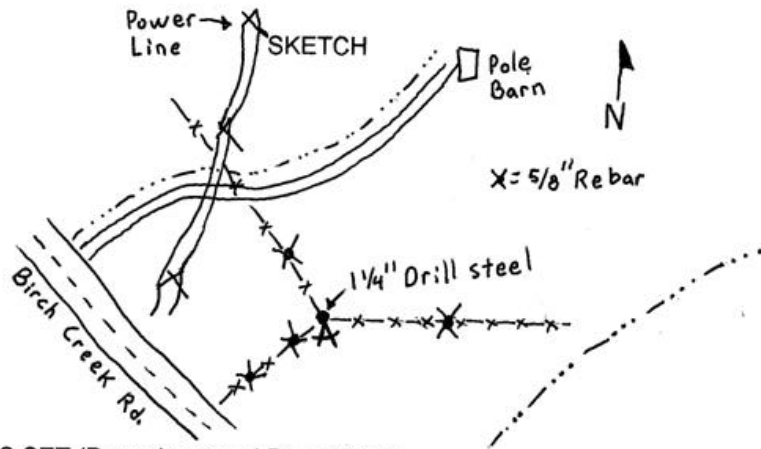
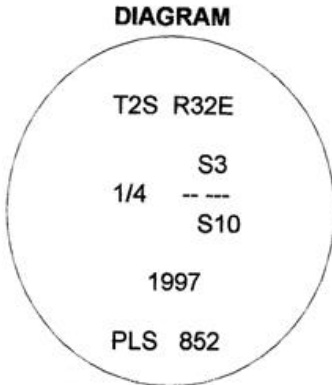

MONUMENT (S) AND ACCESSORIES SET (Procedures and Description)

Set a 1 1/4" x 30" hollow drill steel at the fence corner. Drove the steel into the bedrock.

For references, I set four 5/8" by 24" rebars with 1.25" red plastic caps stamped ORLS 852 and WAL5 13922 as described below:

- a rebar bears N26°15'W, 93.07 feet under the existing fence;
- a rebar bears S42°20'W, 34.48 feet under the existing fence;
- a rebar bears S42°28'W, 72.05 feet under the existing fence;
- a rebar bears N87°55'E, 55.48 feet under the existing fence;

Monument and reference locations were surveyed with GPS receivers in stop and go mode.

The bearings are true. The distances are grid.

Location and comments

Compass Declination

Surveyors Seal

RECEIVED BY:
Umatilla County Surveyor
 Date:
 Rec'd By:
No. 97-132-R

Firm / Agency
 Haddock Surveying
 Address
 P.O. Box 1574
 Pendleton, Or. 97801
 Party Chief
 Stephen K, Haddock

REGISTERED
 PROFESSIONAL
 LAND SURVEYOR

David L. Haddock

OREGON
 JULY 12, 1988
 DAVID L. HADDOCK
 852

RECEIVED BY
Umatilla County Surveyor
 Date 7-97
 Rec'd By SK
 No. 97-132-R

Refer to 97-107-B